



115 Norfolk Avenue

, London, N13 6AL

£580,000



ZUPLEX are delighted to offer this Five Bedroom, Spacious and Modernised Terraced House, located on the quiet residential road of Norfolk Avenue.

Surrounding this property are many local amenities, such as New River Sports Centre and Wood Green Shopping Centre. The property is also just 0.7 miles to Green Lanes High Road where you will find many supermarkets and key transport links. There is also easy access to the A406, being from only a 4 minutes drive away.

The property boasts 4 Double Bedrooms and 1 Single room scattered across the Large Three Story House, 3 of the bedrooms being on the first floor and two loft rooms. There are also Two Bathrooms, Two Reception Rooms and a generously sized Extended Kitchen.

Externally, the home compromises of a Rear Garden with an Outbuilding (SHED) and offers Off Street Parking on the Driveway at the front.



- RECEPTION 1 12'5" x 11'9" (3.81 x 3.6)
- RECEPTION 2 / DINING ROOM 16'1" x 11'1" (4.91 x 3.38)
- KITCHEN 13'0" x 8'1" (3.98 x 2.48)
- BEDROOM 1 12'9" x 9'10" (3.90 x 3.00)
- BEDROOM 2 11'2" x 9'10" (3.41 x 3.00)
- BEDROOM 3 8'1" x 5'7" (2.47 x 1.71)
- BEDROOM 4 15'8" x 8'6" (4.80 x 2.60)
- BEDROOM 5 9'10" x 9'0" (3.02 x 2.76)
- GARDEN 52'5" x 17'4" (16.00 x 5.30)

Area Map



Floor Plans

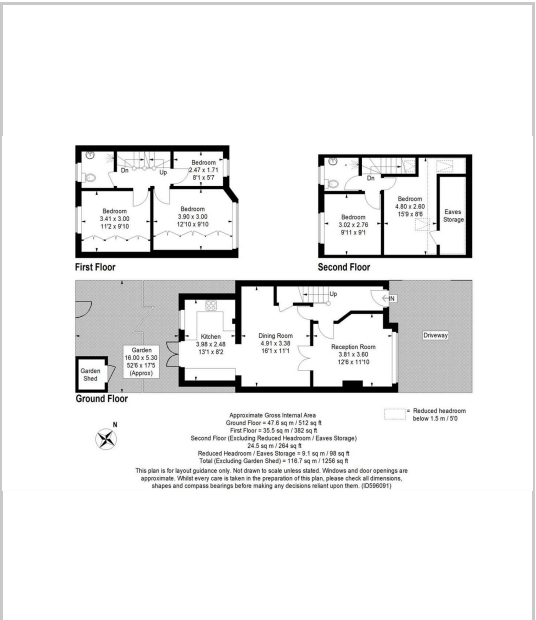

Energy Efficiency Graph

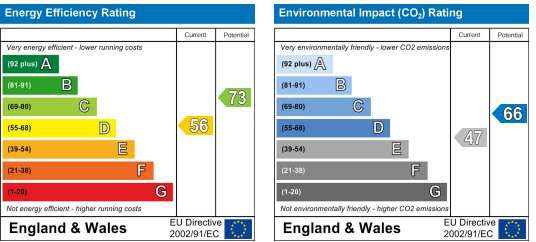

These particulars, whilst believed to be accurate are set out as a general outline only for guidance and do not constitute any part of an offer or contract. Intending purchasers should not rely on them as statements of representation of fact, but must satisfy themselves by inspection or otherwise as to their accuracy. No person in this firms employment has the authority to make or give any representation or warranty in respect of the property.

