



7 Diamond Close

CW2 5JW

£235,000



3



2



1



C



STEPHENSON BROWNE



7 Diamond Close

- Bespoke Finish Throughout
- Tucked Away Location
- Downstairs WC
- Superb Private Large Rear Garden
- Master En-Suite
- Must View Home

Built by Prospect Homes in 2018, Stephenson Browne delight in offering For Sale this rather remarkable recently constructed home which sits on a fantastic plot with a very surprising large rear garden and perhaps an opinion not often associated with a new build home, a very private rear garden. Inside, the standard of finish is high throughout, you will notice this particularly when it comes to the kitchen and bathrooms. In brief the internal accommodation comprises: entrance, WC, spacious living room, stunning dining kitchen with French patio doors opening to the rear, a contemporary family bathroom, three bedrooms (master en-suite) with Bedrooms One and Two benefiting from built in wardrobes. A truly lovely property, one which we look forward to showing you shortly!



Entrance Hall

Entrance door. Tiled floor. Radiator.

Cloakroom

Modesty double glazed window. Low level W.C. Wash hand basin. Complementary tiling. Radiator.

Lounge 16'9" x 16'5" maximum (5.11m x 5.00m maximum)
Double glazed window to the front. Two radiators. TV point. Open plan staircase leading to the first floor.

Kitchen Diner

16'9" x 9'10" (5.11m x 3.00m)
Double glazed French doors opening onto the garden. Double glazed window to the rear. Space for a dining table and chairs. Lovely range of high gloss units comprising a one and a half bowl sink unit with drainer, work surfaces adjacent. Base units under with cupboards and drawers. Wall cabinets over. Built in four ring gas hob with electric oven and grill. Extractor hood. Inset spot lights to ceiling. Concealed fridge and freezer. Integrated washer dryer, integrated dishwasher, integrated fridge freezer. Radiator. Built in under stairs storage. Complementary tiling.

Stairs to First Floor

Double glazed window. Landing giving access to the loft space.

Bedroom One

12'7" x 9'9" (3.84m x 2.97m)
Double glazed window. Radiator. Built in wardrobe.





En-Suite Shower Room

Modesty double glazed window. Built in shower cubicle with wall mounted shower as fitted and glass door. Wash hand basin. Low level W.C. Complementary tiling. Heated towel rail.

Bedroom Two

9'10" x 9'9" (3.00m x 2.97m)

Double glazed window. Radiator. Built in wardrobe.

Bedroom Three

8'5" x 6'8" (2.57m x 2.03m)

Double glazed window. Radiator.

Bathroom

Modesty double glazed window. Full suite comprising a panelled bath with wall mounted shower over and glass screen. Wash hand basin. Low level W.C. Complementary tiling. Heated towel rail.

Externally

The property is tucked nicely within a small cul de sac of similar style homes. There is a driveway providing off road parking which extends down the side of the property. To the rear the garden is enclosed and features a flagged patio and good size lawn.

Tenure

We understand from the vendor that the property is freehold. We would however recommend that your solicitor check the tenure prior to exchange of contracts.

Need to Sell?

For a FREE valuation please call or e-mail and we will be happy to assist.

Directions

From the agent's office turn left along Nantwich Road and proceed to the traffic lights at Wells Green. Turn left into Rope Lane and follow the road to the village of Shavington. At the t-junction turn left into Main Road. At the next junction turn right into Crewe Road and proceed to the traffic lights. Turn left into Newcastle Road and then left again into Diamond Close.





Floor Plans

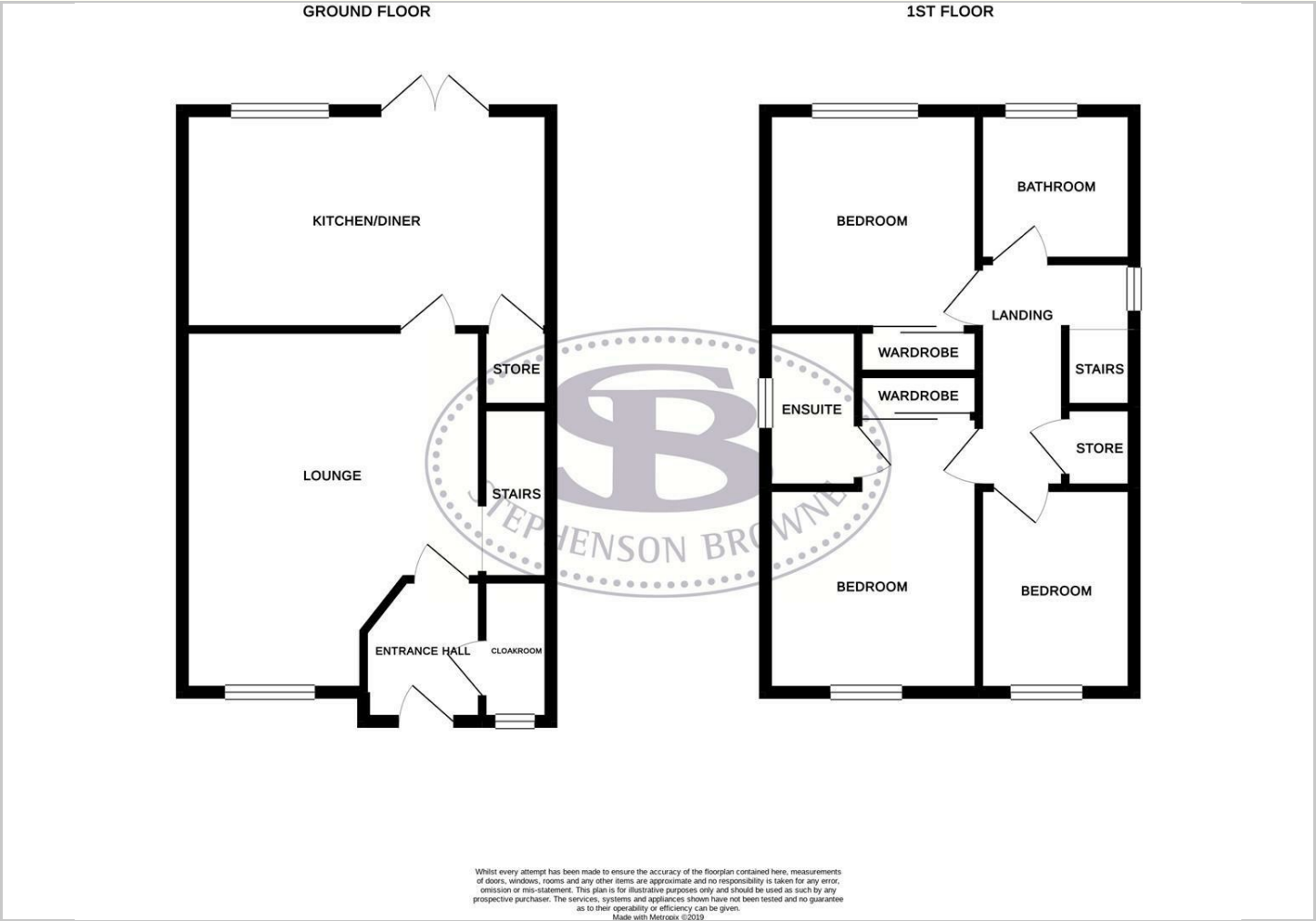

Viewing

Please contact our Crewe Sales Office on 01270 252545 if you wish to arrange a viewing appointment for this property or require further information.

NOTICE: Stephenson Browne for themselves and for the vendors or lessors of this property whose agents they are give notice that: (1) the particulars are set out as a general guideline only for the guidance of intending purchasers or lessees, and do not constitute, nor constitute part of, an offer or contract; (2) all descriptions, dimensions, references to condition and necessary permissions for use and occupation, and other details are given in good faith and are believed to be correct but any intending purchasers or tenants should not rely on them as statements or representations of fact but must satisfy themselves by inspection or otherwise as to the correctness of each theme; (3) no person in the employment of Stephenson Browne has any authority to make representation or warranty whatever in relation to this property. (4) fixtures & fittings are subject to a formal list supplied by the vendors solicitors. **Referring to:** Move with Us Ltd **Average Fee:** £123.64

Location Map



Energy Performance Graph

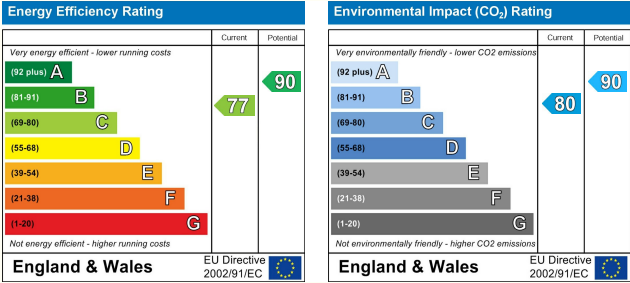

234 Nantwich Road, Crewe, Cheshire, CW2 6BP

T: 01270 252545 E: crewe@stephensombrowne.co.uk | www.stephensombrowne.co.uk