



Harvard Road, Hither Green,  
London, SE13 6SE  
£1,700 pcm

Mark Beaumont estate agents are pleased to offer to rent this modernised Victorian House. The house has just been refurbished which includes a new fitted kitchen and new bathroom as well as complete decoration and floor coverings. Downstairs there is: An Entrance Hall, Twin Reception Rooms, the newly fitted kitchen and bathroom. Upstairs there are three bedrooms, two of which a good sized doubles. There is a garden to the rear. The house is in a residential cul-de-sac between, Lewisham, Hither Green and Ladywell stations. Available to rent now.



**GROUND FLOOR**  
APPROX. 41.2 SQ. METRES (443.3 SQ. FEET)

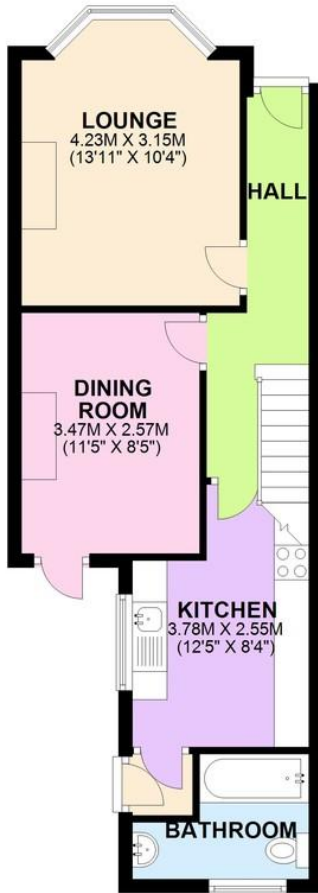

**FIRST FLOOR**  
APPROX. 36.6 SQ. METRES (393.6 SQ. FEET)



TOTAL AREA: APPROX. 77.8 SQ. METRES (836.9 SQ. FEET)

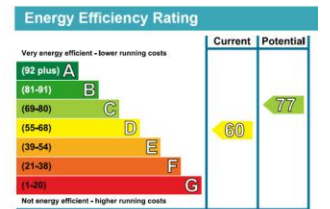

South London Branch  
197 Lewisham High  
Street  
London  
SE13 6AA

www.markbeaumont.com  
lettings@markbeaumont.co  
m  
020 8852 5000

Agents Note: Whilst every care has been taken to prepare these particulars, they are for guidance purposes only. All measurements are approximate and for general guidance purposes only and whilst every care has been taken to ensure their accuracy, they should not be relied upon and we advise to recheck the measurements. All inclusive tenancy start-up fee £399. Includes: VAT, References, Administration Charge, Tenancy Agreement. (up to 2 tenants). Additional Tenants charged at £150 inclusive, per additional tenant. Guarant or fee's: £150 per guarantor. (Where necessary). Check out fee from £80 - £120 depending on the size of the property. Ask for a scale of charges in branch. Holding Deposit: £200