



5, Custom House Redcliffe Backs, Bristol, BS1 6NE

A wonderful furnished apartment in this well-respected development affording stunning views over the Floating Harbour to Welshback. This first floor apartment comprises an open plan kitchen and reception/dining room with a balcony, a master double bedroom with walk-in dressing room and en-suite shower, a second double bedroom with fitted wardrobes and the main bathroom with a shower over the bath. The flat also benefits from a secure underground car parking space. Please note that the apartment is available for a minimum 12 month tenancy. EPC rating C (79).

£1,450 PCM* Fees Apply

Redcliffe Backs, Bristol

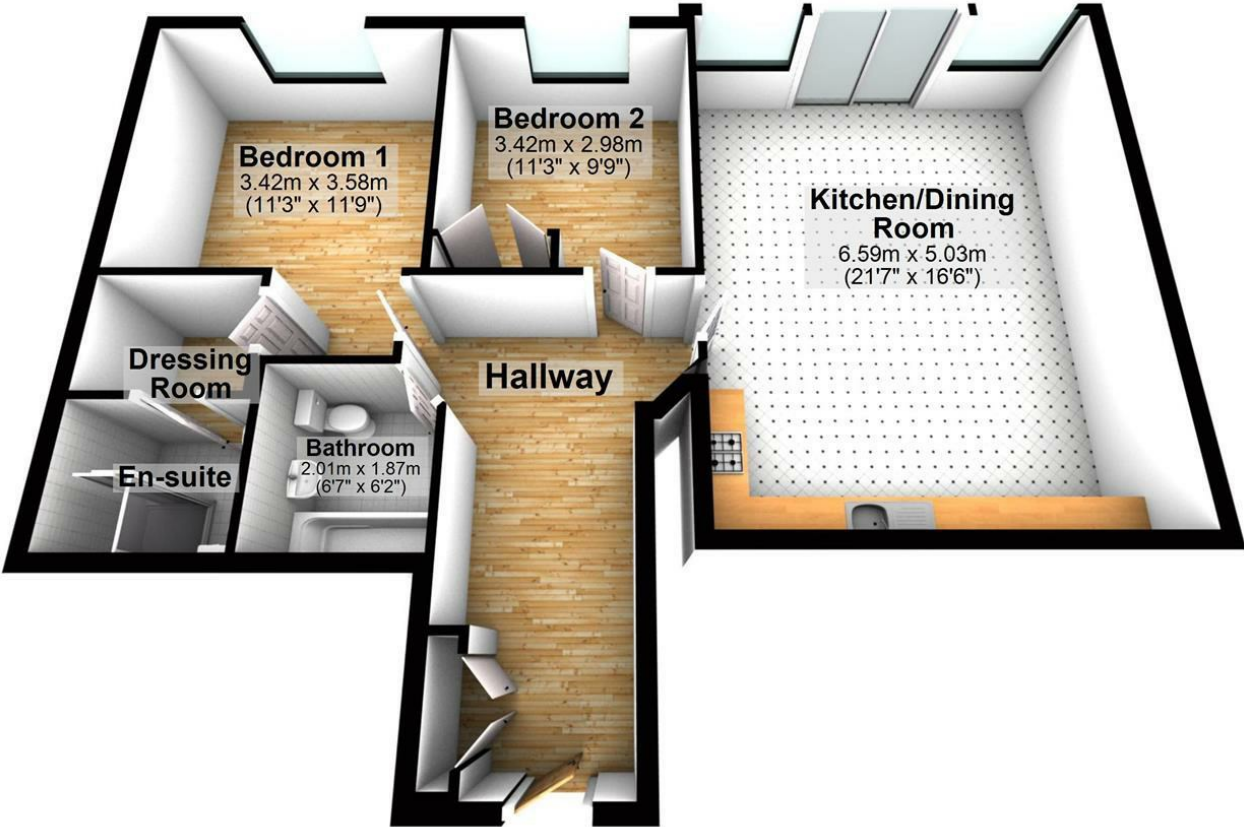

Whilst Hydes of Bristol endeavours to ensure floorplans be as accurate as possible, the measurements of any items within the property (such as windows, doors and walls) are approximate and no responsibility can be taken for any error.
Plan produced using PlanUp.

Energy Efficiency Rating		Current	Potential
Very energy efficient - lower running costs			
(92 plus) A			
(81-91) B			
(69-80) C			
(55-68) D			
(39-54) E			
(21-38) F			
(1-20) G			
Not energy efficient - higher running costs			
England & Wales		79	81
		EU Directive 2002/91/EC	

Environmental Impact (CO ₂) Rating		Current	Potential
Very environmentally friendly - lower CO ₂ emissions			
(92 plus) A			
(81-91) B			
(69-80) C			
(55-68) D			
(39-54) E			
(21-38) F			
(1-20) G			
Not environmentally friendly - higher CO ₂ emissions			
England & Wales			
		EU Directive 2002/91/EC	