

## 2 Lazonby Way, Westerhope, NE5 4EP

Price £37,500 Leasehold

25% SHARED OWNERSHIP

Two bedroom link-detached house situated on popular residential estate. The property briefly comprises of spacious lounge, fitted kitchen, two double bedrooms, bathroom and guest WC, with private rear garden and driveway parking to the front.

There is a monthly rent of £262.41 per month and service charges of £31.73 per month payable, based on 25% shared ownership.

Floor Plan

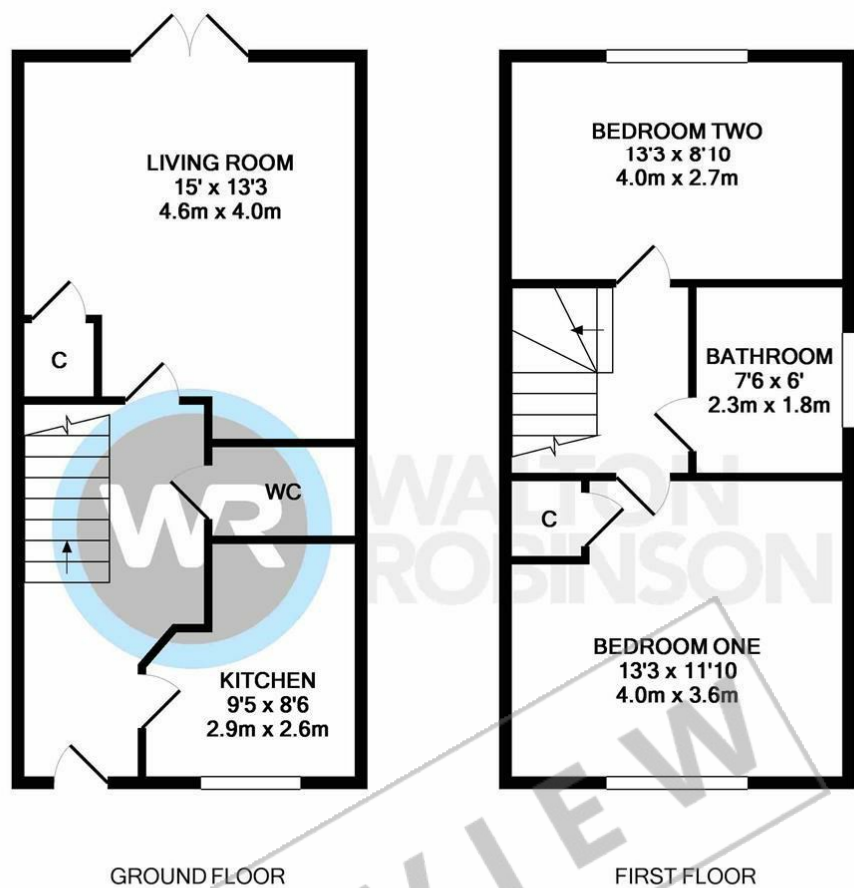

Whilst every attempt has been made to ensure the accuracy of the floor plan contained here, measurements of doors, windows, rooms and any other items are approximate and no responsibility is taken for any error, omission, or mis-statement. This plan is for illustrative purposes only and should be used as such by any prospective purchaser. The services, systems and appliances shown have not been tested and no guarantee as to their operability or efficiency can be given  
Made with Metropix ©2019

Area Map



Energy Efficiency Graph

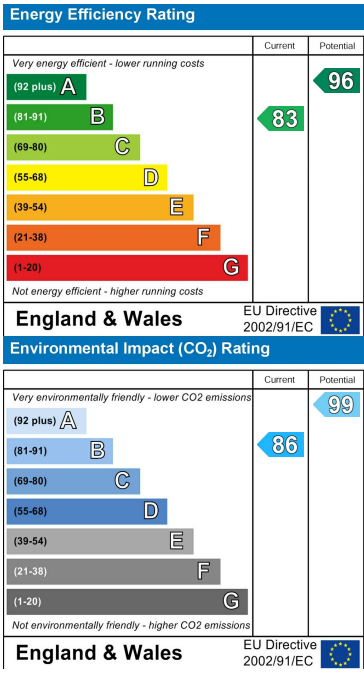

These particulars, whilst believed to be accurate are set out as a general outline only for guidance and do not constitute any part of an offer or contract. Intending purchasers should not rely on them as statements of representation of fact, but must satisfy themselves by inspection or otherwise as to their accuracy. No person in this firms employment has the authority to make or give any representation or warranty in respect of the property.