



**Kingsway, North Finchley, N12**

**£165,000**

 1 Bedroom    1 Bathroom    1 Reception





North Finchley Office

365 Ballards Lane, North Finchley, London, N12 8LL

Tel: 020 8445 4008 Email: [info@adam-hayes.co.uk](mailto:info@adam-hayes.co.uk) Web: [www.adam-hayes.co.uk](http://www.adam-hayes.co.uk)

# Kingsway, North Finchley, N12

## £165,000

 1 Bedroom  1 Bathroom  1 Reception

### Key Features

- One Bedroom
- First Floor Retirement Apartment
- Reception with Open Plan Kitchen
- Three Piece Bathroom Suite
- Communal Gardens
- Communal Parking

### Nearest Stations

Woodside Park (0.5 miles)

West Finchley (0.5 miles)

Finchley Central (1.0 miles)

### Property Description

Situated in this popular warden assisted block and within minutes' walk of North Finchley's multiple local shops, transport facilities and amenities is this one bedroom, first floor flat retirement apartment. The property benefits from a reception with open plan kitchen, double glazing, a three piece bathroom suite, communal gardens and communal parking. However to really appreciate the size, location and facilities an internal viewing is highly recommended via vendors main agents Adam Hayes Estate Agents on 020 8445 4008.

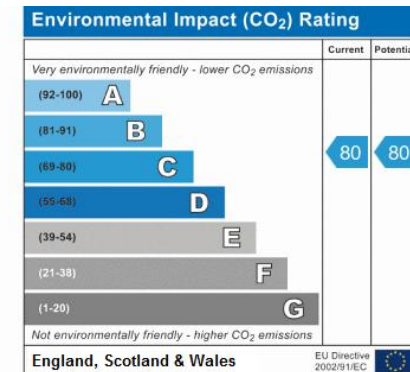
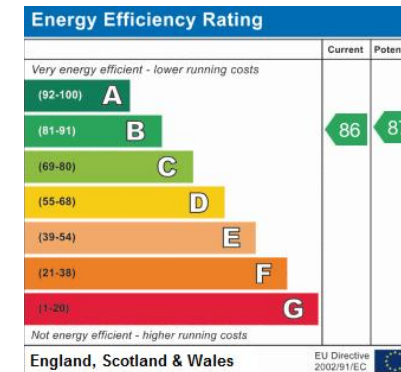

North Finchley Office

365 Ballards Lane, North Finchley, London, N12 8LL

Tel: 020 8445 4008 Email: [info@adam-hayes.co.uk](mailto:info@adam-hayes.co.uk) Web: [www.adam-hayes.co.uk](http://www.adam-hayes.co.uk)

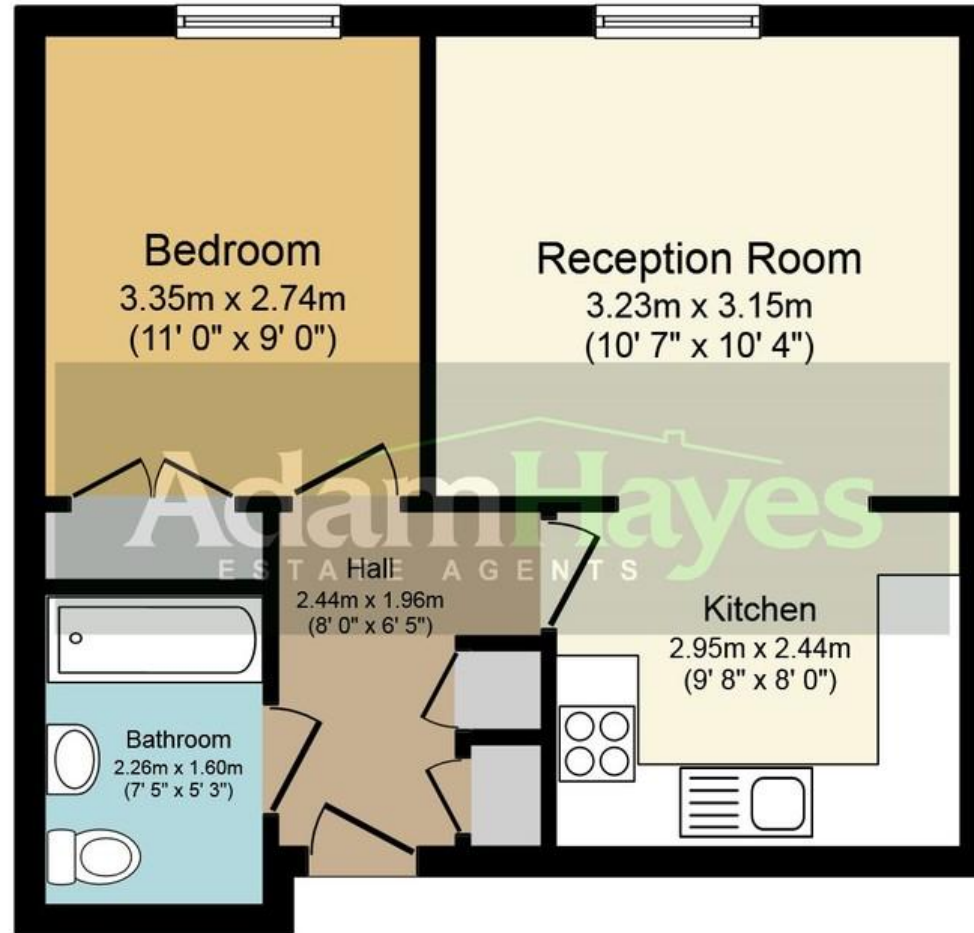

## Floor Plan

Total floor area 40.0 sq. m. (431 sq. ft.) approx

This plan is for illustration purposes only and may not be representative of the property. Plan not to scale.

These particulars, whilst believed to be accurate are set out as a general outline only for guidance and do not constitute any part of an offer or contract. Intending purchasers should not rely on them as statements or representation of fact, but must satisfy themselves by inspection or otherwise as to their accuracy. We have not carried out a detailed survey not tested the services, appliances and specific fittings. Room sizes should not be relied upon for carpets and furnishings. The measurements given are approximate. No person in this firms employment has the authority to make or give any representation or warranty in respect of the property.