

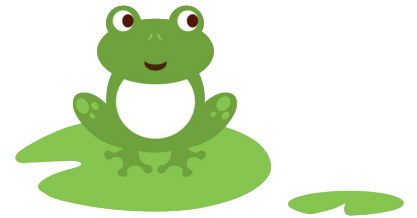

ESTATES

MANAGEMENT, SALES & LETTINGS



285 Upperthorpe, Crookesmoor, Sheffield, S6 3NG

£79.50 PPPW

Viewing highly recommended on this outstanding 5 bedroom student house over 3 floors. Ideal for University of Sheffield Students. Comprises of 5 larger than most double bedrooms. Modern bathroom with shower over bath, sink and WC. Separate downstairs wet room. Huge fully fitted kitchen diner with ample storage space for 5 people. Driveway parking for several cars and an extensive garden - perfect for barbeques!

£1,725 Per Calendar Month

Available: 1st July 2020

- Outstanding 5 bed property
- 2 new bathrooms
- Driveway for several cars
- Extensive garden area
- Short walk to University
- Easy on street parking
- Newly fitted kitchen
- Good local facilities
- All inclusive option available on request



T: 0114 272 7787 | E: info@bps-estates.co.uk | www.bps-estates.co.uk



ESTATES

MANAGEMENT, SALES & LETTINGS

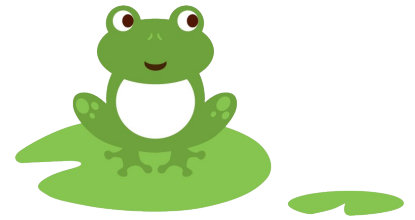

Ground Floor



First Floor

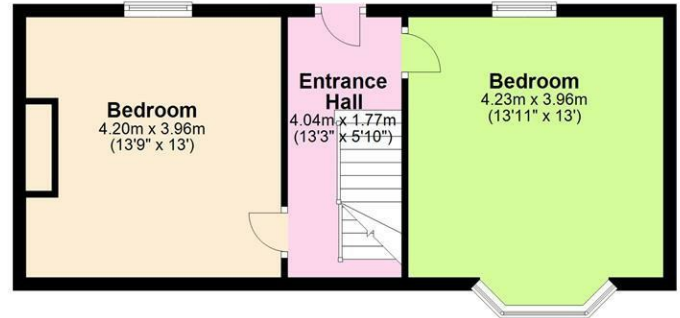

Second Floor

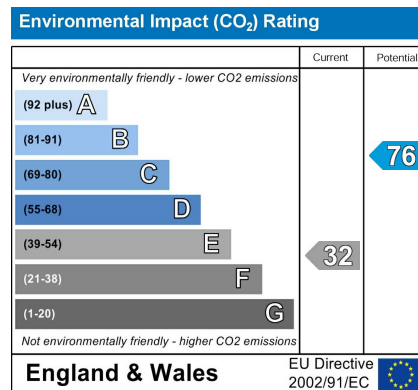
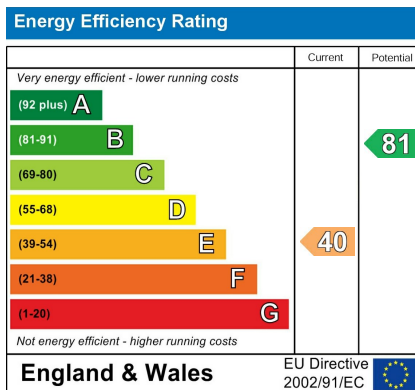
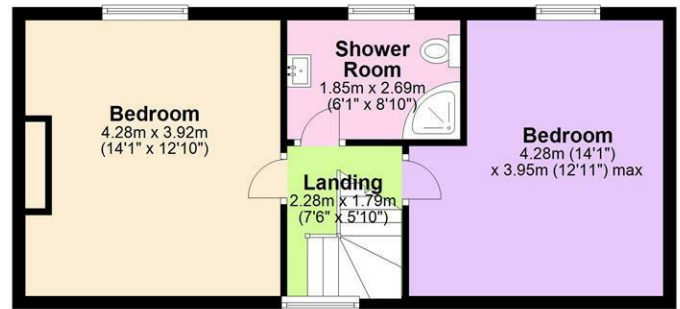

BPS Estates (Part of Broomhill Property Shop)
319 Glossop Road, Sheffield, S10 2HP
T: 0114 272 7787 | E: info@bps-estates.co.uk
W: www.bps-estates.co.uk