



Crownstone Road, Brixton, SW2

£550,000

2 bedroom flat - purpose built for sale

Property Details

A two double bedroom flat is nestled quietly on the second floor of a characterful Victorian mansion block on Crownstone Road. The property has 700 square feet of internal living space and comprises a separate living room at the front of the building with original features, a modern kitchen with ample dining space and two double bedrooms which share a contemporary bathroom. A set of stairs lead down to a connected set of communal gardens. Effra Mansions is positioned with a supermarket at the end of the road and it's a three-minute walk from Brockwell Park and within a ten-minute stroll to Brixton town centre. The restaurants and cafes in Herne Hill are all within a pleasant fifteen-minute walk through Brockwell Park.

Features

- Two double bedrooms
- Period mansion block
- Characterful features
- Communal garden
- 700 square feet of internal living space
- Three-minute walk to Brockwell Park
- A ten-minute walk to Brixton tube station

Council tax band C EPC rating D (57)





Crownstone Road, Brixton, SW2



2 Bed flat

Approx internal area:

700 sqft 65 sqm

While we do try our very best, floor plans are produced as a guide only and we take no responsibility for the precise accuracy with which any property is represented

Crownstone Road

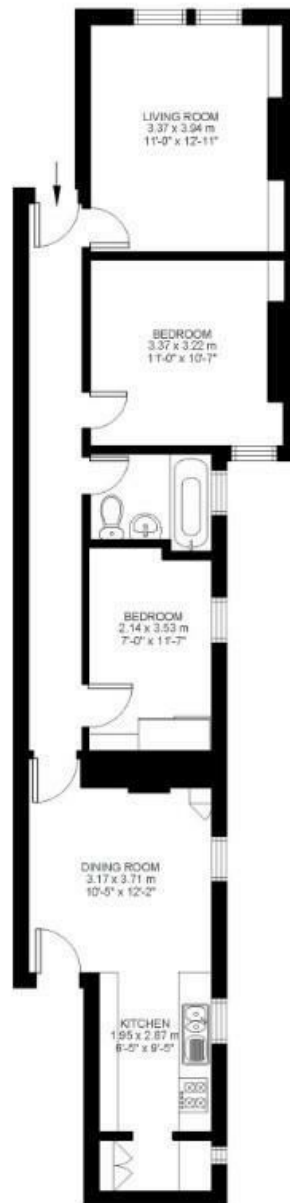

Second Floor



Crownstone Road, Brixton, SW2

