

Collingwood Road, N15 4LD

£399,995 FREEHOLD

A two bedroom mid-terrace period house located on a popular residential street. The property requires modernisation and is an ideal opportunity to refurbish to one's individual taste. Benefits include a through lounge, kitchen/diner, private rear garden, downstairs bathroom and two double bedrooms. Collingwood Road is situated within close proximity to Seven Sisters Underground- BR Station (Victoria Line) and within a short stroll of Tottenham Green Leisure Centre, the Bernie Grant Arts Centre and the award winning Downhills Park with its superb community café, tennis courts and children's play area.

****Offered with no onward chain****

T: 0208 888 0022 E: turnpikelane@wilkinsonbyrne.com W: www.wilkinsonbyrne.com



Collingwood Road, Tottenham, Worthing, N15

APPROX. GROSS INTERNAL FLOOR AREA 779 SQ FT 72.4 SQ METRES

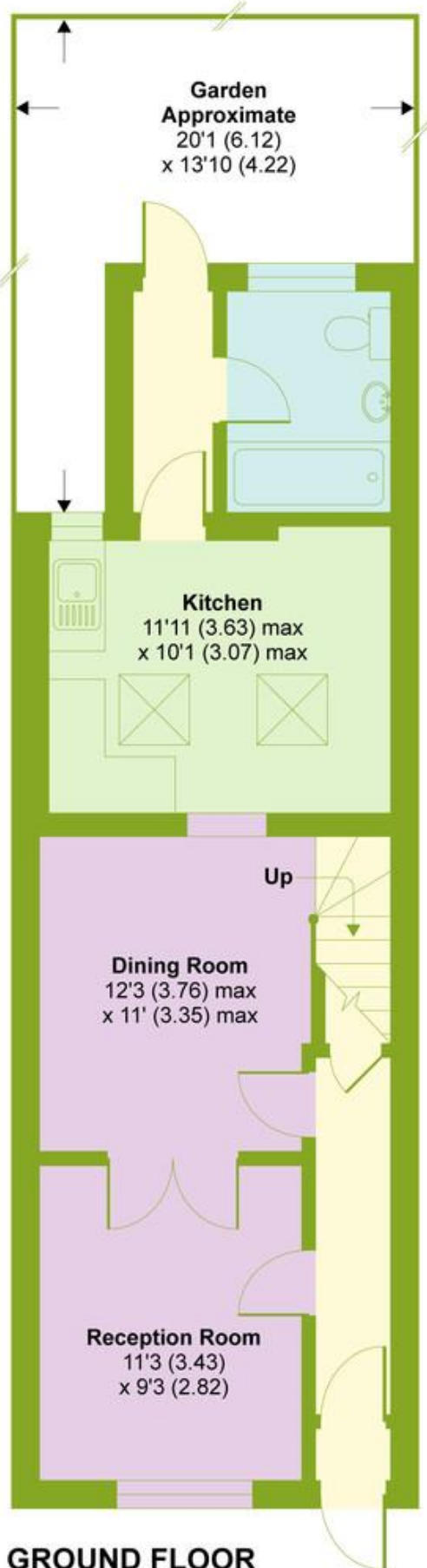

GROUND FLOOR

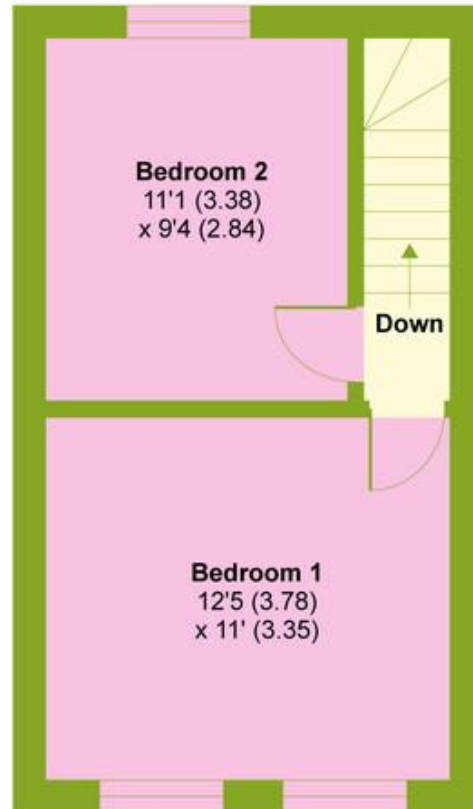

FIRST FLOOR



Bounds Green Office
3 Latham Court
Brownlow Road
London N11 2ES
0208 - 365 - 8900
boundsgreen@wilkinsonbyrne.com

Turnpike Lane Office
8 Turnpike Parade
Green Lanes
London N15 3EA
0208 - 888 - 0022
turnpikelane@wilkinsonbyrne.com