



5 Sorrel Close, Luton, Bedfordshire, LU3 4AE  
£870 PCM





- Two Bedrooms
- Parking Available
- Sainsburys & Schools Close By
- Must Be Viewed

- Barton Hills
- Immediate Move In
- Fitted Kitchen

- Private Rear Garden
- Park Views
- Gas CH

\*\*\* P&R Property Lettings \*\*\* Two Bedroom Terraced \*\*\* Barton Hills Location \*\*\* PARK VIEWS ON YOUR FRONT DOORSTEP \*\*\* Quiet Close Location \*\*\* Parking Available \*\*\* Private Rear Garden \*\*\* 2 Minute Walk To Sainsburys \*\*\* Local Schools Nearby \*\*\* Available For Immediate Move In \*\*\* Must Be Viewed \*\*\*

## ENTRANCE HALL

**LOUNGE 14'11" X 13'5" (4.55M X 4.09M)**

**KITCHEN/DINER 8'2" X 13'5" (2.50M X 4.09M)**

## LANDING

**BEDROOM 1 11'1" X 13'5" (3.39M X 4.09M)**

**BEDROOM 2 12'0" X 7'8" (3.66M X 2.34M)**

## BATHROOM

## OUTSIDE

Ground Floor



First Floor

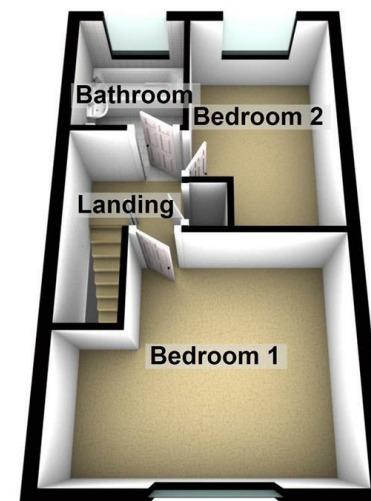

Energy Efficiency Rating		Current	Potential
Very energy efficient - lower running costs			
(92 plus)	A		
(81-91)	B		
(69-80)	C		
(55-68)	D		
(39-54)	E		
(21-38)	F		
(1-20)	G		
Not energy efficient - higher running costs			
England & Wales		EU Directive 2002/91/EC	