



28 Cicero Drive, Luton, Bedfordshire, LU3 4DA
£750

- Barton Hills Location
- White Goods Included

- REFURBISHED
- Parking Available

- Fitted Kitchen
- Must Be Viewed

*** P&R Property Lettings *** NEWLY REFURBISHED ONE BEDROOM MAISONETTE *** Fabulous Luxury Maisonette *** Fully Fitted Kitchen Inc White Goods ***
BARTON HILLS LOCATION *** Large Double Bedroom With Storage *** MUST BE VIEWED ***

LANDING 7'06 X 2'11 (2.29M X 0.89M)

Stairs leading to front door, doors leading to all rooms, storage cupboard

LIVING ROOM 13'08 X 10'11 (4.17M X 3.33M)

Double glazed window to front

KITCHEN 12'04 X 5'08 (3.76M X 1.73M)

Fitted kitchen including wall and base mounted units, washing machine, fridge freezer and cooker

BEDROOM 12'03 X 10'05 (3.73M X 3.18M)

Double glazed window to rear

BATHROOM

Fitted bathroom including bath, shower, basin and WC

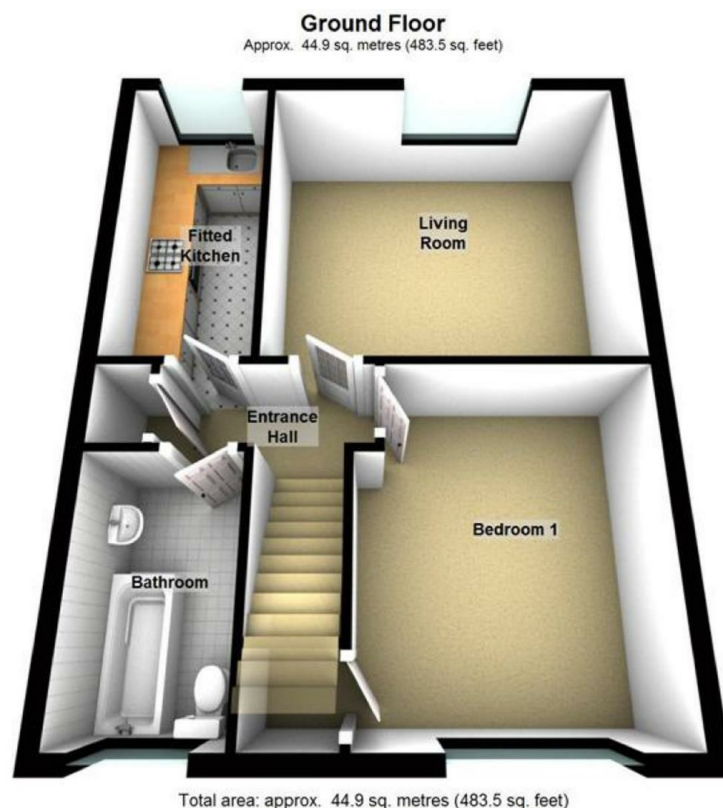

Energy Efficiency Rating		
	Current	Potential
Very energy efficient - lower running costs		
(92 plus) A		
(81-91) B		
(69-80) C		
(55-68) D		
(39-54) E		
(21-38) F		
(1-20) G		
Not energy efficient - higher running costs		
England & Wales		EU Directive 2002/91/EC