



Sophora House,  
London, SW11 8BW  
£1,500,000 Leasehold

GARTON JONES.COM



Vista Chelsea Bridge,  
Sophora House,  
London, SW11 8BW

£1,500,000 Leasehold



Stylish two bedroom apartment located on the fifth floor in the Vista Sophora Building at Chelsea Bridge Wharf. Spacious open plan kitchen with beautiful stone work surface finishes and a beautifully designed lounge area. Master bedroom with en-suite bathroom. Second bedroom and separate bathroom. Large windows and private terrace with views of the iconic Battersea Power Station. Fully equipped residents gym and 24-hour concierge. An opportunity to acquire an “off plan” apartment due for completion in 2016 located in the beautiful, sculptural building called Vista, Chelsea Bridge Wharf. Located between the wide open spaces of Battersea Park and the exciting redevelopment of Battersea Power Station. The breath taking design of the building is matched by the luxury finishes internally and fabulous views. Lease 999 years aprox, Service Charge £4.38 per sq/ft approximately.

- Two bedroom, two bathroom
- Views facing Power Station
- Terrace
- Open plan Kitchen and Reception
- 840 sq ft
- Fifth floor
- 24 hour Concierge

**Sophora House, SW11**

Approximate Gross Internal Area 78 sq m / 840 sq ft

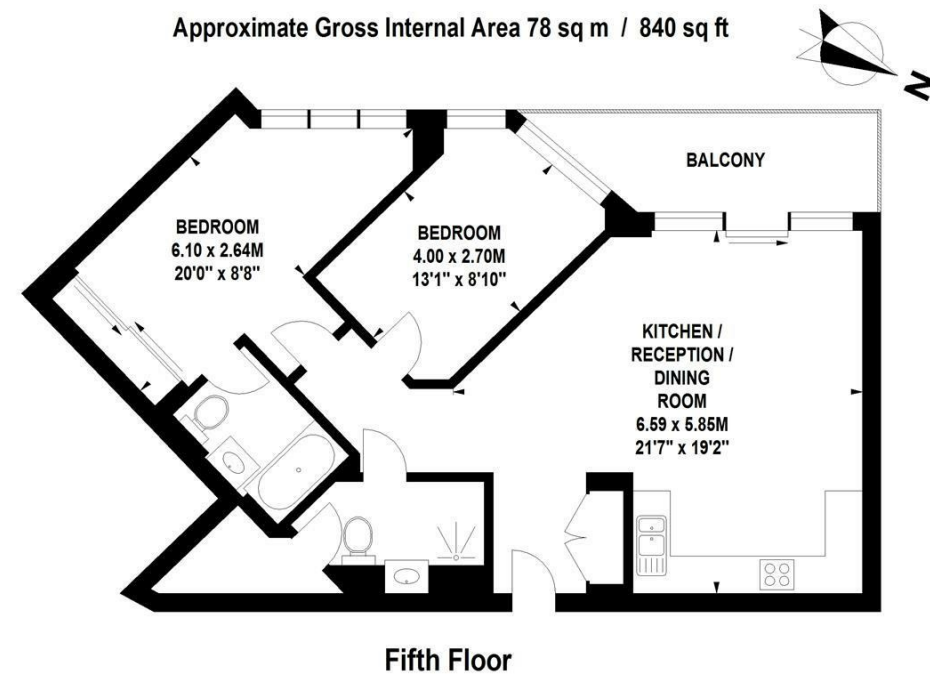

Floor Plan produced for Garton Jones by Mays Floorplans © . Tel 020 3397 4594  
Illustration for identification purposes only, not to scale  
All measurements are maximum, and include wardrobes and window bays where applicable