

David
Astburys
ESTATE AGENTS



North View Road, Crouch End N8
Offers in Excess of £475,000
Share of Freehold

15 Park Road, Crouch End, London, N8 8TE
davidastburys.com
0203 000 6787 | sales@davidastburys.com

15 Park Road, Crouch End, London, N8 8TE
davidastburys.com
0203 000 6787 | sales@davidastburys.com

- Private Garden
- Private Entrance
- First Floor
- Share of Freehold
- 727 Square Feet
- Separate Reception
- Separate Kitchen
- Chain Free



North View Road, N8

Approximate Gross Internal Area
67.5 sq m / 727 sq ft

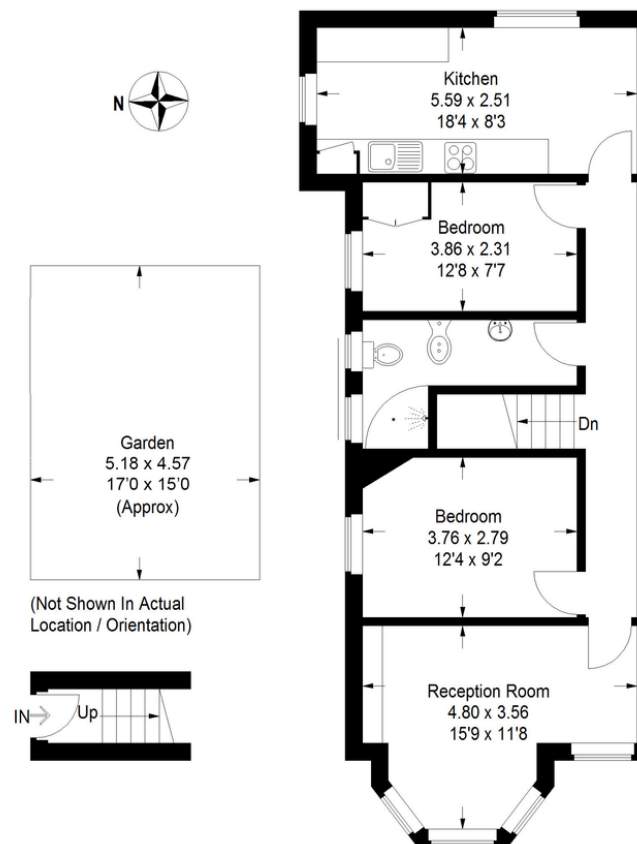

Measured in accordance with RICS Code of Measuring Practice. To be used for identification and guidance purposes only.
Whilst every care is taken in the preparation of this plan, please check all dimensions, shapes and compass bearings before making any decision reliant upon them.
www.davidastburys.co.uk ©2017 davidastburys.co.uk

Agents Note: Whilst every care has been taken to prepare these sales particulars, they are for guidance purposes only. All measurements are approximate and are for general guidance purposes only and whilst every care has been taken to ensure their accuracy, they should not be relied upon and potential buyers are advised to recheck the measurements.

