



Elm Place
Bath, BA2 2AB

£1,200 pcm

Property Summary

A newly renovated unfurnished garden apartment on the Bear Flat with convenient access to the City Centre. A well behaved pet may be considered. Available to let immediately.



A newly renovated unfurnished garden apartment on the Bear Flat. The property benefits from a complete renovation to include a new kitchen, bathroom, shower room, décor and carpets. Close to the Bear Flat amenities and bus route into the City Centre. A large garden is to the rear for the exclusive use of the property as well as private parking at the rear and very pleasant views from inside the property. This property would suite a couple or 2 professional sharers. A well behaved pet may be considered. Available to let immediately.

GROUND FLOOR
40.8 sq. m. (440 sq. ft.) approx.

1ST FLOOR
82.2 sq. m. (885 sq. ft.) approx.

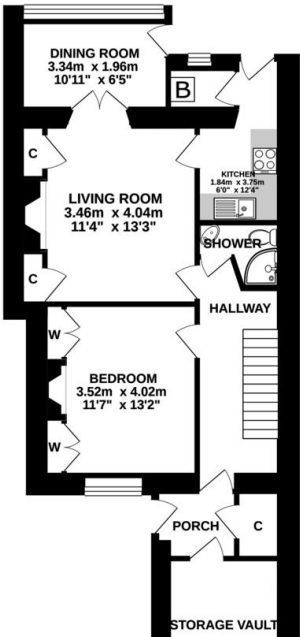
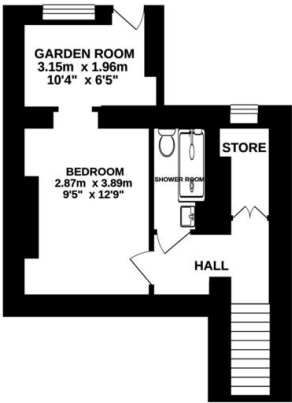

TOTAL FLOOR AREA: 123.0 sq. m. (1324 sq. ft.) approx.
Whilst every attempt has been made to ensure the accuracy of the floorplan contained here, measurements of doors, windows, rooms and any other items are approximate and no responsibility is taken for any error, omission or mis-statement. This plan is for illustrative purposes only and should be used as such for any prospective purchase. The services, systems and appliances shown have not been tested and no guarantee is given to their operability or efficiency can be given.
Made with Metrigio 10/2019

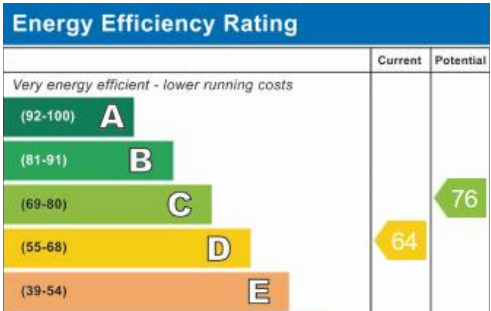

- New Carpets
- New Kitchen
- New Bathroom
- New Shower Room
- Newly Decorated
- Close to Amenities
- Gas Central Heating
- Large Garden
- Private Parking
-

30 Charles Street
Bath
Avon
BA1 1HU

www.propertylinkestates.com
bath@propertylinkestates.com
01225 447440

Agent's Note: Whilst every care has been taken to prepare these lettings particulars, they are for guidance purposes only. All measurements are approximate are for general guidance purposes only and whilst every care has been taken to ensure their accuracy, they should not be relied upon and potential tenants are advised to recheck the measurements.