



jordanfishwick

DIDSBURY
Ladysmith Road



Ladysmith Road, Didsbury M20 6HL

Offers in excess of £260,000



The Property

A garden fronted terrace property enjoying an ideal location on a small cul-de-sac which is within a 'short stroll' of Didsbury Village and the Metrolink. In outline comprising:- Front porch, lounge, breakfast kitchen fitted with a range of units and with stairs leading to the first floor, inner lobby giving access to the enclosed rear courtyard and a downstairs bathroom with white suite. Whilst to the first floor, are two good sized double bedrooms. The property is warmed by gas fired central heating, which is further complemented by uPVC double glazing. In addition to the front garden, there is an enclosed flagged courtyard garden to the rear. *NO ONWARD CHAIN*

Directions

From our office proceed along Wilmslow Road in a northerly direction turning right at the traffic lights onto School Lane. Take the 6th turning on the right hand side into Ladysmith Road and the property can then be found on the right hand side.

- Garden fronted terrace
- Two double bedrooms
- Lounge & breakfast kitchen
- Bathroom with white suite
- Porch & inner lobby
- uPVC double glazing
- Gas central heating
- Cul-de-sac location
- Close to Didsbury Village
- No onward chain

Postcode - M20 6HL

EPC Rating - D

Floor Area - 591 sq ft

Local Authority - Manchester City Council

Council Tax - Band B



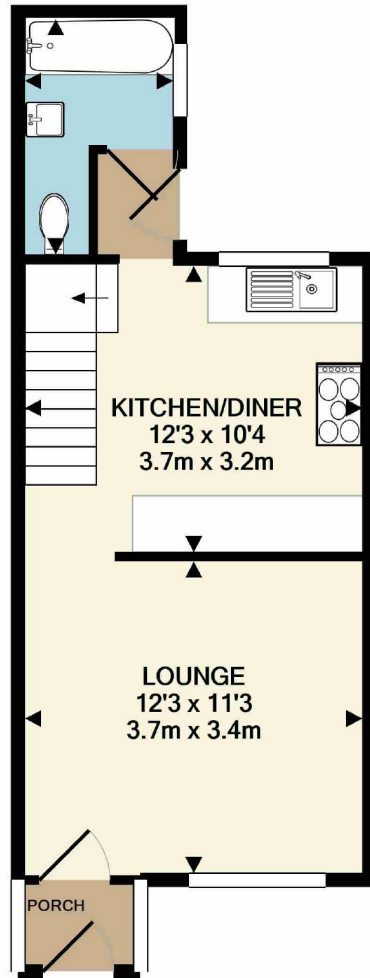

GROUND FLOOR
APPROX. FLOOR
AREA 327 SQ.FT.
(30.3 SQ.M.)

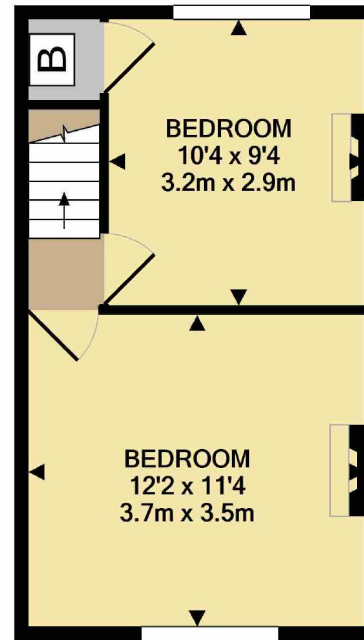

1ST FLOOR
APPROX. FLOOR
AREA 265 SQ.FT.
(24.6 SQ.M.)

TOTAL APPROX. FLOOR AREA 591 SQ.FT. (54.9 SQ.M.)
Measurements are approximate. Not to scale. Illustrative purposes only
Made with Metropix ©2019



These particulars are believed to be accurate but they are not guaranteed and do not form a contract. Neither Jordan Fishwick nor the vendor or lessor accept any responsibility in respect of these particulars, which are not intended to be statements or representations of fact and any intending purchaser or lessee must satisfy himself by inspection or otherwise as to the correctness of each of the statements contained in these particulars. Any floorplans on this brochure are for illustrative purposes only and are not necessarily to scale.

Offices also at: Wilmslow, Macclesfield, Hale, Sale, Chorlton, Glossop, Manchester & Salford

757-759 Wilmslow Road, Didsbury Village, Manchester

0161 445 4480

didsbury@jordanfishwick.co.uk
www.jordanfishwick.co.uk