





Hiltons Estates brings to the market this Brilliant Opportunity to purchase a spacious studio apartment located in Southall, UB2, with Long Lease Remaining of 993 years! The property comes with secure phone entry system and is located on the second floor. This property is located in Urban Southall and walking distance to Southall Rail Station (Cross Rail 2019), local shops, schools and amenities. There are ample bus links and good transport links to Heathrow, Central London, M4, M25, M40 and A40! This is an Excellent opportunity for First Time Buyers, Commuters and Investors!!! Viewings Highly Recommended!!! Book Now!

Spacious Studio apartment located in Southall, UB2, with Long Lease Remaining of 993years.

Located in Urban Southall and walking distance to Southall Rail Station (Cross Rail 2019), local sch

Bus links and good transport links to Heathrow, Central London, M4, M25, M40 and A40!

Excellent opportunity for First Time Buyers, Commuters and Investors!!! Viewings Highly Recommended!



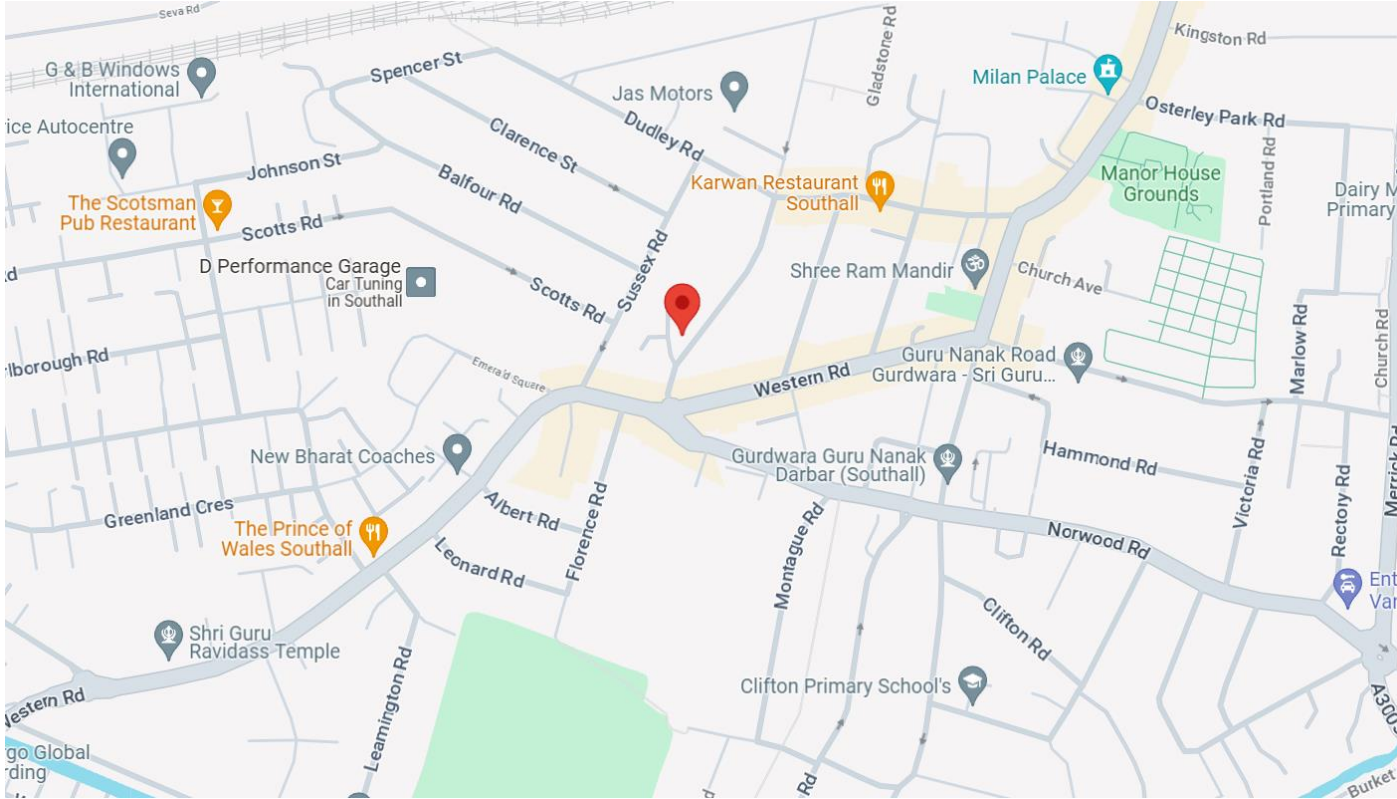

GROUND FLOOR
573 sq.ft. (53.2 sq.m.) approx.

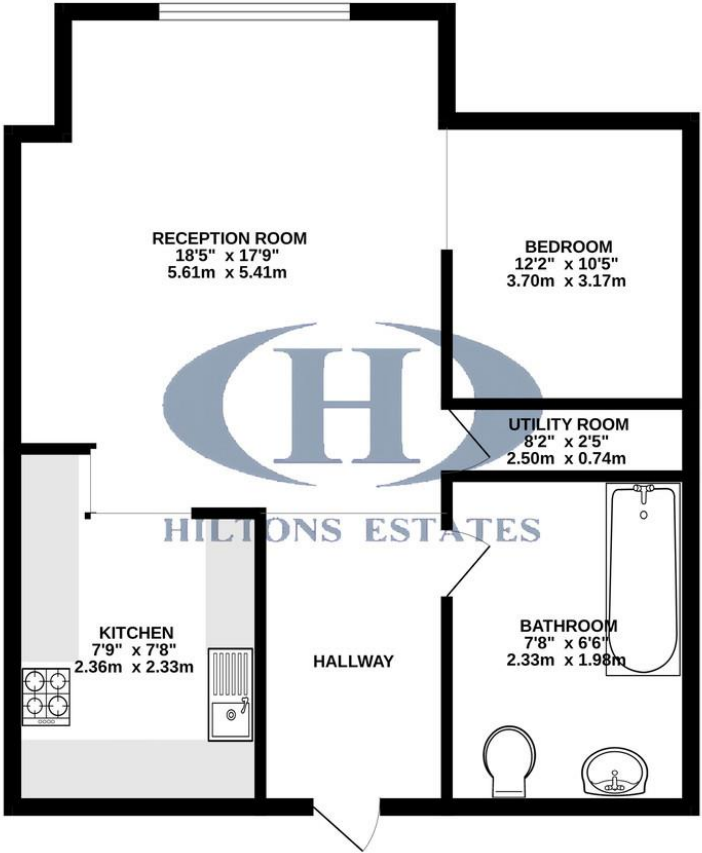

TOTAL FLOOR AREA : 573 sq.ft. (53.2 sq.m.) approx.

Whilst every attempt has been made to ensure the accuracy of the floorplan contained here, measurements of doors, windows, rooms and any other items are approximate and no responsibility is taken for any error, omission or mis-statement. This plan is for illustrative purposes only and should be used as such by any prospective purchaser. The services, systems and appliances shown have not been tested and no guarantee as to their operability or efficiency can be given.
Made with Metropix ©2023

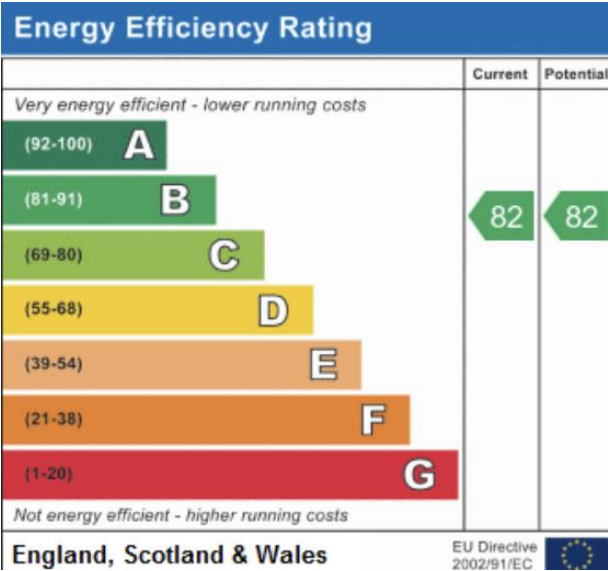

Hiltons Estates, 137 Western Road
Southall, UB2 5HN

www.hiltons-estates.com
email: harvin@hiltons-estates.com
0208 867 9555 / 07961 527301

Agents Note: Whilst every care has been taken to prepare these sales particulars, they are for guidance purposes only. All measurements are approximate and for general guidance purposes only and whilst every care has been taken to ensure their accuracy, they should not be relied upon and potential buyers are advised to recheck the measurements.