

020 8653 3444



- Stunning 3 Bedroom E.O.T House
- Garage + Off Street Parking
- Stunning Kitchen
- Stunning First Floor Bathroom
- Gas Central Heating (N/T)

## Falkland Park Avenue, South Norwood, London, SE25 6SH

Amazing Modernised Three Bedroom End of Terrace House. This home is located in one of South London's prime areas close to Grangewood Park, Crystal Palace Triangle and Norwood Junction Overground Station with its fast trains to London Bridge. Features; Superb open plan lounge / dining room, Stunning fitted kitchen with integrated units, Stunning first floor bathroom, 3 bedrooms, Gas Central heating (n/t), Double glazing, Garage, Off street parking and Terraced courtyard style rear garden. EPC Rating E. Call Now to View and Avoid Missing Out on this Stunning Home!

**£535,000**

## Property Description

### 3 BEDROOM END OF TERRACE

Amazing Modernised Three Bedroom End of Terrace House. This home is located in one of South London's prime areas close to Grangewood Park, Crystal Palace Triangle and Norwood Junction Overground Station with its fast trains to London Bridge. Features; Superb open plan lounge / dining room, Stunning fitted kitchen with integrated units, Stunning first floor bathroom, 3 bedrooms, Gas Central heating (n/t), Double glazing, Garage, Off street parking and Terraced courtyard style rear garden. EPC Rating E. Call Now to View and Avoid Missing Out on this Stunning Home!

### ENTRANCE HALL

### OPEN PLAN LOUNGE / DINING ROOM

### STUNNING KITCHEN WITH INTEGRATED APPLIANCES

### FIRST FLOOR LANDING

### STUNNING FIRST FLOOR FAMILY BATHROOM WITH SEPERATE SHOWER CUBICLE

### BEDROOM 1

### BEDROOM 2

### BEDROOM 3

### GARAGE

### TERRACED COURTYARD STYLE REAR GARDEN







OFF STREET PARKING



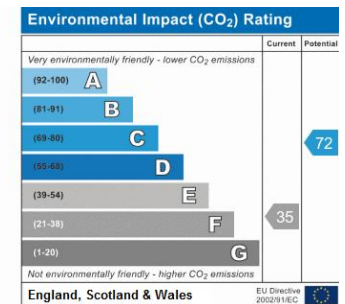
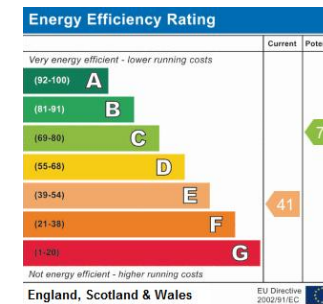
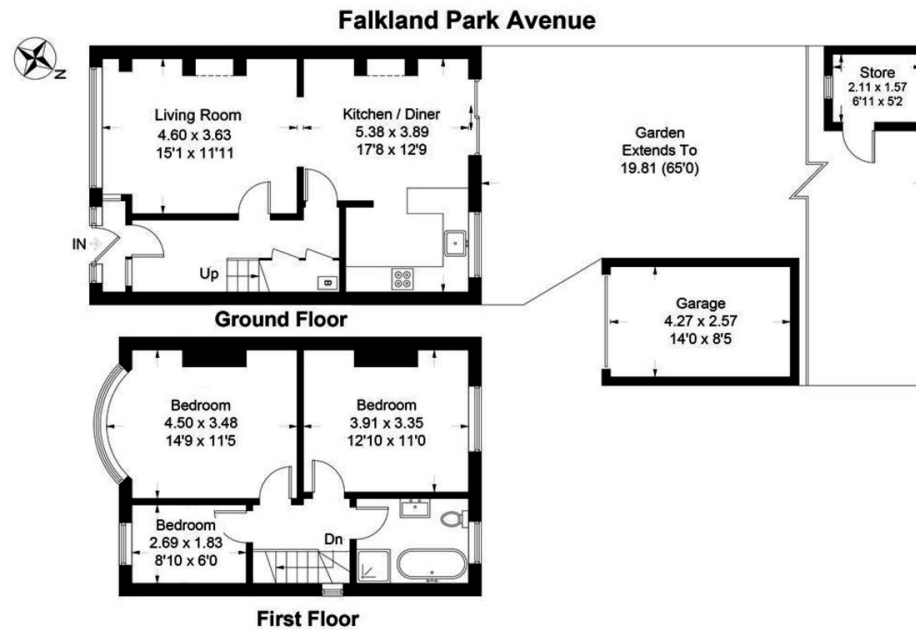

Benson & Partners Ltd  
4 – 6 Station Road  
London  
SE25 5AJ

southnorwood@bensonpartners.co.uk  
020 8653 3444

Agents Note: Whilst every care has been taken to prepare these sales particulars, they are for guidance purposes only. All measurements are approximate and are for general guidance purposes only and whilst every care has been taken to ensure their accuracy, they should not be relied upon and potential buyers are advised to recheck the measurements.