

# Woodholls



## **Coppice Way, Aylesbury, HP20 1XQ** **£650**

A lovely one bedroom first floor maisonette situated just a short walk from the town centre and Stocklake Business park.  
With allocate parking for residents.  
Offered unfurnished and available to view from the 18th December

44 Buckingham Street, Aylesbury, Bucks, HP20 2LL  
Telephone: 01296 433 393 Email: [info@woodholls.co.uk](mailto:info@woodholls.co.uk) Website: [www.woodholls.co.uk](http://www.woodholls.co.uk)



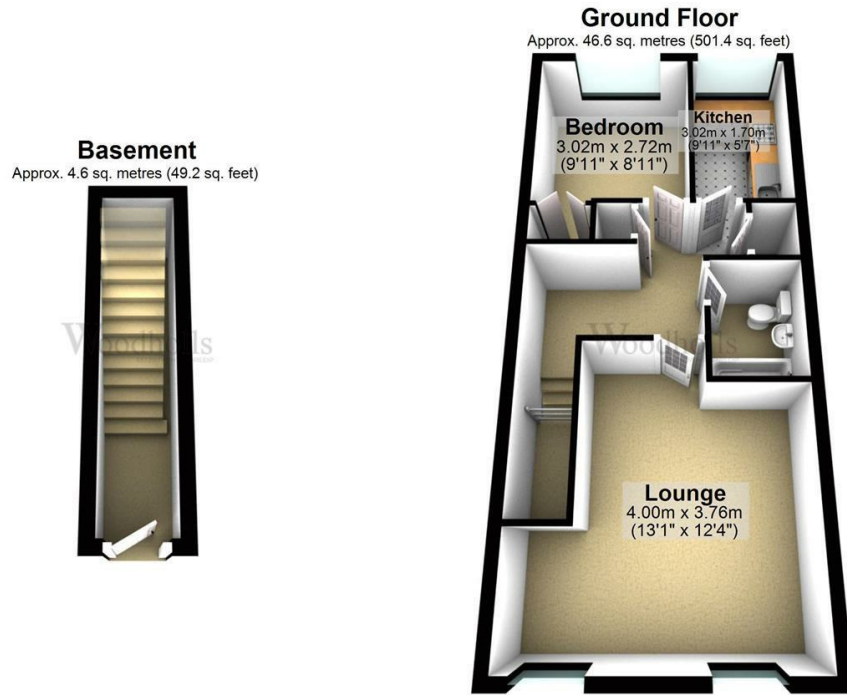

Total area: approx. 51.2 sq. metres (550.6 sq. feet)



Energy Efficiency Rating		
	Current	Potential
Very energy efficient - lower running costs		
(92 plus) <b>A</b>		<b>82</b>
(81-91) <b>B</b>		
(69-80) <b>C</b>	<b>71</b>	
(55-68) <b>D</b>		
(39-54) <b>E</b>		
(21-38) <b>F</b>		
(1-20) <b>G</b>		
Not energy efficient - higher running costs		
<b>England &amp; Wales</b> EU Directive 2002/91/EC		
Environmental Impact (CO <sub>2</sub> ) Rating		
	Current	Potential
Very environmentally friendly - lower CO <sub>2</sub> emissions		
(92 plus) <b>A</b>		<b>73</b>
(81-91) <b>B</b>		
(69-80) <b>C</b>		
(55-68) <b>D</b>	<b>56</b>	
(39-54) <b>E</b>		
(21-38) <b>F</b>		
(1-20) <b>G</b>		
Not environmentally friendly - higher CO <sub>2</sub> emissions		
<b>England &amp; Wales</b> EU Directive 2002/91/EC		

44 Buckingham Street, Aylesbury, Bucks, HP20 2LL

Telephone: 01296 433 393 Email: [info@woodholls.co.uk](mailto:info@woodholls.co.uk) Website: [www.woodholls.co.uk](http://www.woodholls.co.uk)