

**3 Crown Terrace
Flat 3
Aberdeen**

Ground Floor

Approx. 35.2 sq. metres (378.8 sq. feet)

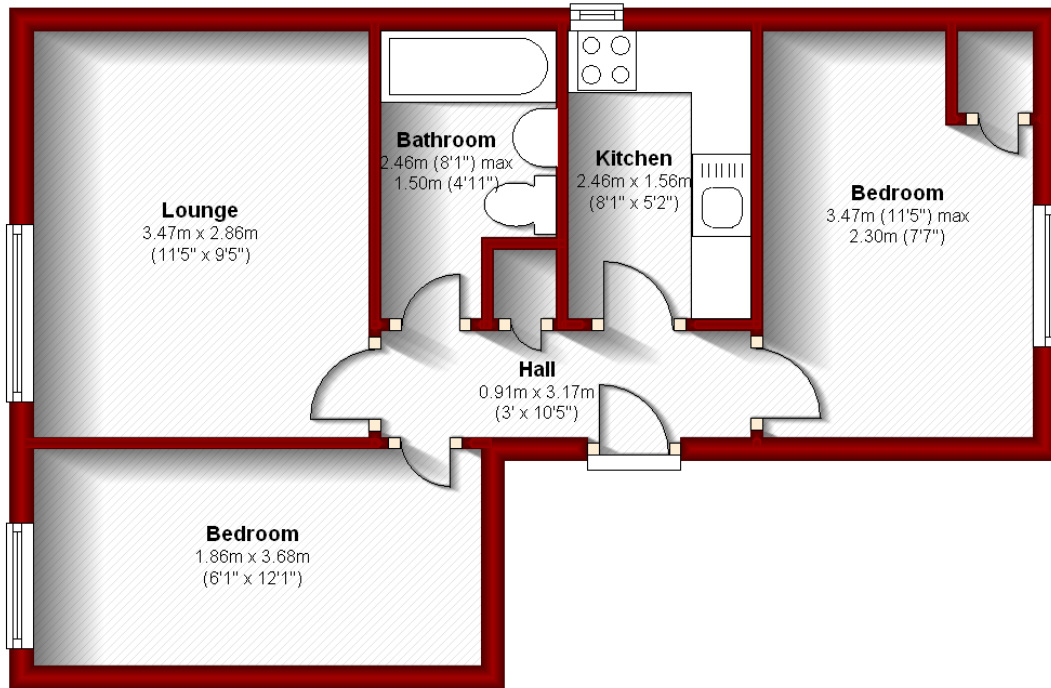

Total area: approx. 35.2 sq. metres (378.8 sq. feet)

The above particulars are for guidance only, no liability for any errors or omissions will be accepted by Aberdeen Property Leasing Ltd.