

STANFORD

— ESTATES —

[www.stanfordestates.london](http://www.stanfordestates.london)



1 bedroom

£1,350 Per month

Manor Lane, Lee



[stanfordestates.london](http://stanfordestates.london)



# Read all about it...

A beautiful one bedroom, ground floor flat conveniently located on Manor Lane, just 0.4 miles away from Hither Green Station and local shops.

The property consists of a lounge, fitted kitchen with pantry, large bedroom with fitted wardrobes, bathroom and a conservatory to the rear. Other features include, large amounts of storage and fitted kitchen appliances, including a gas hob, oven and fridge freezer.

Offered part furnished and available from 28th of February 2019

Council : Lewisham  
Council Tax Band : B

Approx floor area: 707.00 sq ft

- Large one bed flat
- Ground floor
- 0.4 miles from the station
- Part furnished
- Private landscaped garden
- Available 28th February

To arrange a viewing please call us on: **020 8852 0026**



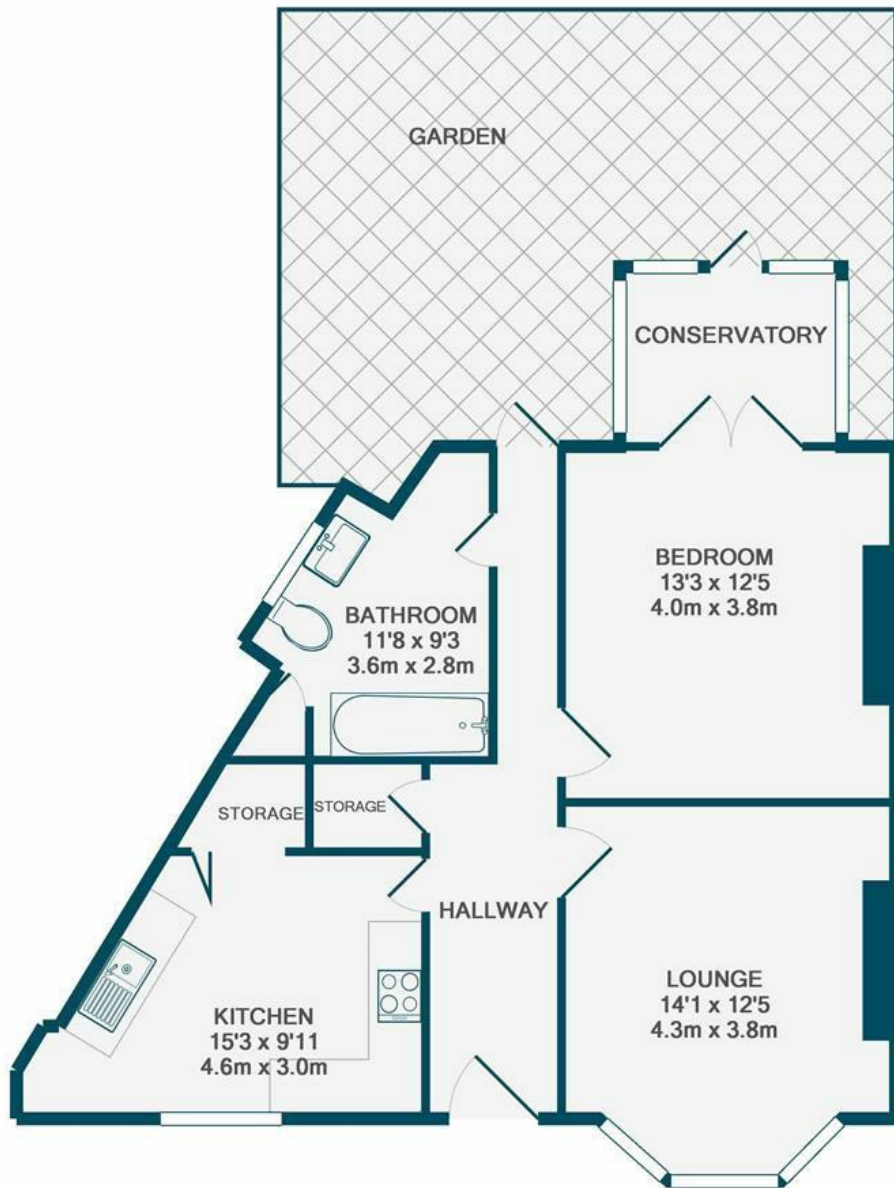

TOTAL APPROX. FLOOR AREA 707 SQ.FT. (65.7 SQ.M.)

Whilst every attempt has been made to ensure the accuracy of the floor plan contained here, measurements of doors, windows, rooms and any other items are approximate and no responsibility is taken for any error, omission, or mis-statement. This plan is for illustrative purposes only and should be used as such by any prospective purchaser. The services, systems and appliances shown have not been tested and no guarantee as to their operability or efficiency can be given

Made with Metropix ©2019

## GROUND FLOOR

### Entrance Hall

Carpet floors, leads on to all other rooms and entrance to garden, storage cupboard

### Lounge

14'1 x 12'5

Single glazed windows to front, carpet, radiator, fireplace

### Kitchen

15'3 x 9'11

Single glazed window to front, matching wall and base units, door to pantry/storage, gas hob, oven, fridge freezer

### Bedroom

13'3 x 12'5

Doors leading on to conservatory, carpet, radiator, fireplace, fitted wardrobes.

### Conservatory

Double glazed windows to garden, tiled floor, door to garden.

### Bathroom

11'8 x 9'3

Double glazed window to side, tiled flooring, bath, shower, toilet, built in cupboards

## OUTSIDE

### Private Rear Garden

Shed, flower beds, laid to lawn.

### Energy Efficiency Rating

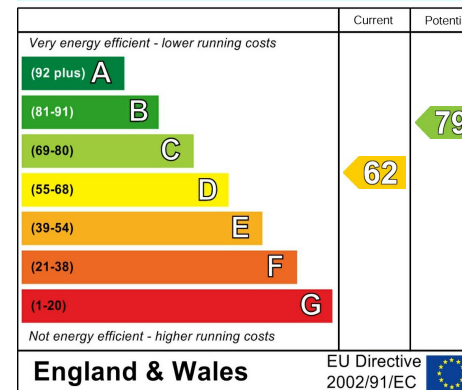

### Environmental Impact (CO<sub>2</sub>) Rating

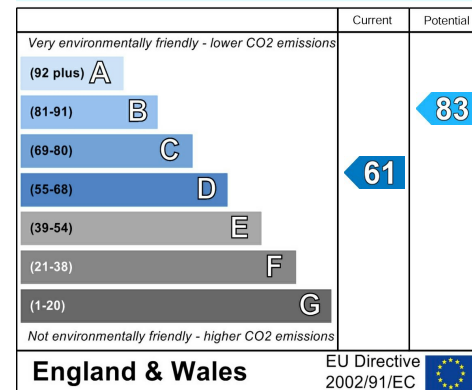





# STANFORD

ESTATES

[www.stanfordestates.london](http://www.stanfordestates.london)

Viewer notes...



The details contained within these particulars are made available for information only. Whilst Robert Stanford Estates Limited makes every effort to ensure that information is accurate, complete and up to date, we make no representations or warranties of any kind, express or implied, about the information and as such we cannot be held responsible for omissions, errors or inaccuracies, nor for any loss or damage including without limitation, indirect or consequential loss or damage, or any loss of profits resulting from direct or indirect actions based upon the content. Robert Stanford Estates Limited has made every effort to ensure that measurements, details and floorplans within our particulars are accurate. However, they are only an approximate general guide and the property particulars are produced in accordance with the Consumer Rights Act (2015) and should not be construed as a contract or offer. Any lease, ground rent, photographs, service charge and distance details cannot be guaranteed for accuracy and as such they should be checked by a solicitor prior to any contract. You should not regard, or take anything, within these particulars as being financial advice.

This disclaimer is governed by and to be construed in accordance with the laws of England and Wales. Any reliance you place on information within these particulars is therefore strictly at your own risk.