

FOR SALE



Caledonian Court, Eastwell Road

2 Bedrooms, 1 Bathroom, flat

Offers In Region Of £95,000

MARTIN&CO



29 Caledonian Court

- Modern mid Floor apartment
- Bright Lounge With Open Aspect
- Double Glazing
- Security Entry
- investment opportunity

| Energy Efficiency Rating | | |
|---|-------------------------|-----------|
| | Current | Potential |
| Very energy efficient - lower running costs | | |
| (92-100) A | | |
| (81-91) B | | |
| (69-80) C | | |
| (55-68) D | 68 | 81 |
| (39-54) E | | |
| (21-38) F | | |
| (1-20) G | | |
| Not energy efficient - higher running costs | | |
| Scotland | EU Directive 2002/91/EC | |

| Environmental (CO ₂) Impact Rating | | |
|---|-------------------------|-----------|
| | Current | Potential |
| Very environmentally friendly - lower CO ₂ emissions | | |
| (92-100) A | | |
| (81-91) B | | |
| (69-80) C | | |
| (55-68) D | 58 | 74 |
| (39-54) E | | |
| (21-38) F | | |
| (1-20) G | | |
| Not environmentally friendly - higher CO ₂ emissions | | |
| Scotland | EU Directive 2002/91/EC | |

We are delighted to introduce to the market this spacious mid Floor apartment, with open aspects to the Stack, located within the popular Caledonian Court development.

The well proportioned accommodation comprises Entrance Hall, Lounge modern fitted Kitchen with wall and base units, There are two double Bedrooms, large store room/office /study fitted bathroom with electric shower over bath

This property will appeal to many purchasers including first time buyers and buy to let investors. The shared gardens to front and rear are mainly laid to lawn with paved patio area.

An allocated private parking spot is an excellent feature of this property.

With its secure door entry system this accommodation is perfect for those looking for a stylish home which is close to all local amenities, transport links and retail opportunities.

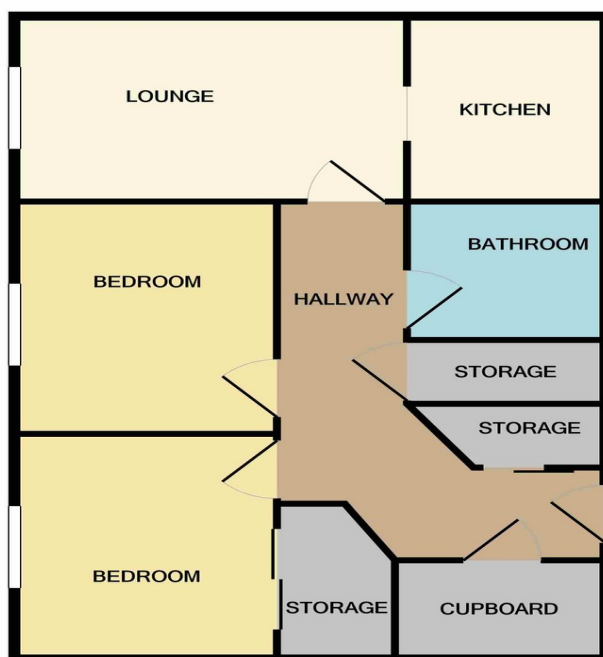

TOTAL APPROX. FLOOR AREA 805 SQ.FT. (74.8 SQ.M.)

Whilst every attempt has been made to ensure the accuracy of the floor plan contained here, measurements of doors, windows, rooms and any other items are approximate and no responsibility is taken for any error, omission, or mis-statement. This plan is for illustrative purposes only and should be used as such by any prospective purchaser. The services, systems and appliances shown have not been tested and no guarantee as to their operability or efficiency can be given

Made with Metropix ©2020

Martin & Co Dundee

33 Albert Square • Meadowside • Dundee • DD1 1DJ
T: 01382 313580 • E: dundee@martinco.com

01382 313580
<http://www.martinco.com>



Accuracy: References to the Tenure of a Property are based on information supplied by the Seller. The Agent has not had sight of the title documents. A Buyer is advised to obtain verification from their Solicitor. Items shown in photographs including but not limited to carpets, fixtures and fittings are not included unless specifically mentioned within the sales particulars. They may however be available by separate negotiation. Buyers must check the availability of any property and make an appointment to view before embarking on any journey to see a property. No person in the employment of the agent has any authority to make any representation about the property, and accordingly any information given is entirely without responsibility on the part of the agents, sellers(s) or lessors(s). Any property particulars are not an offer or contract, nor form part of one. **Sonic / laser Tape:** Measurements taken using a sonic / laser tape measure may be subject to a small margin of error. **All Measurements:** All Measurements are Approximate. **Services Not tested:** The Agent has not tested any apparatus, equipment, fixtures and fittings or services and so cannot verify that they are in working order or fit for the purpose. A Buyer is advised to obtain verification from their Solicitor or Surveyor. **Mortgage & Financial Advice:** The Martin & Co mortgage service is provided by London & Country Mortgages the UK's largest Independent Fee-Free mortgage broker of Beazer House, Lower Bristol Road, Bath, BA2 3BA. Authorised and regulated by the Financial Conduct Authority. Their FCA number is 143002. YOUR HOME IS AT RISK IF YOU DO NOT KEEP UP REPAYMENTS ON A MORTGAGE OR OTHER LOANS SECURED ON IT. Full written quotation available on request. A suitable life policy may be required. Loans subject to status. Minimum age 18. If you are making a cash offer, we shall require written confirmation of the source and availability of your funds in order that our client may make an informed decision

