



*jordan*fishwick

BUXTON ROAD
Newtown, Disley, Stockport



**282 Buxton Road, Newtown, Disley,
Stockport, Cheshire SK12 2PY**

£220,000



The Property

*** STUNNING FREEHOLD NEW HOME*** Forming part of a select and highly desirable development in Newtown, Disley, this delightful, contemporary THREE BEDROOM DETACHED is beautifully appointed throughout and complimented with fabulous QUALITY FITTED kitchen with INTEGRATED APPLIANCES and STYLISH BATHROOM. SOUTH FACING rear garden and off road parking for two cars. High energy rating and an economical combination boiler in addition to the virtually maintenance free exterior, will keep running costs to a minimum. Comprising: entrance hall, wc, fitted kitchen, living room, two first floor bedrooms, PLUS STUDY, bathroom, second floor attic bedroom. For further details please contact the Disley Office 01663 767878.

Locality

Part of a select development of nine new homes and are ideally located in Newtown, Disley. Bordering Cheshire and the High Peak lying in the foothills of Kinder Scout. Nearby railway links provide great access to Manchester Piccadilly and the busy market town of Stockport. Neighbouring New Mills, Whaley Bridge and Disley offer an array of local shops, pubs and restaurants.

- Three Bed Detached Plus Study
- Brand New Home
- Select Development
- 10 Year LABC Warranty
- Fitted Kitchen
- Contemporary Styling
- Enclosed Gardens and Parking for Two Cars
- FREEHOLD

Postcode - SK12 2PY

EPC Rating -

Local Authority - Cheshire East

Council Tax - Band TBC



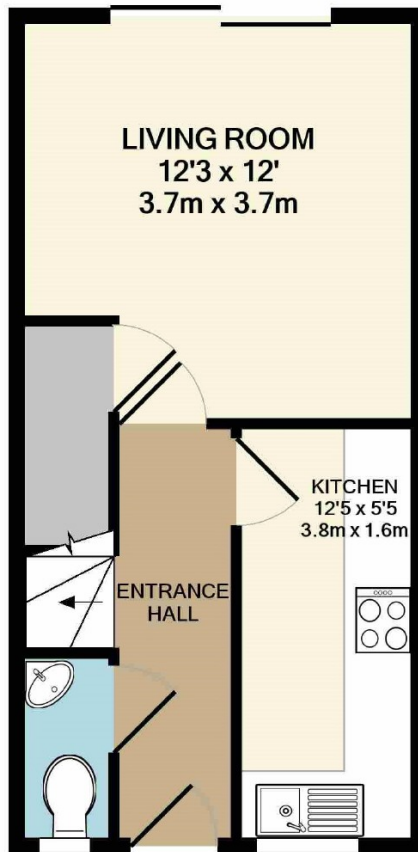

GROUND FLOOR

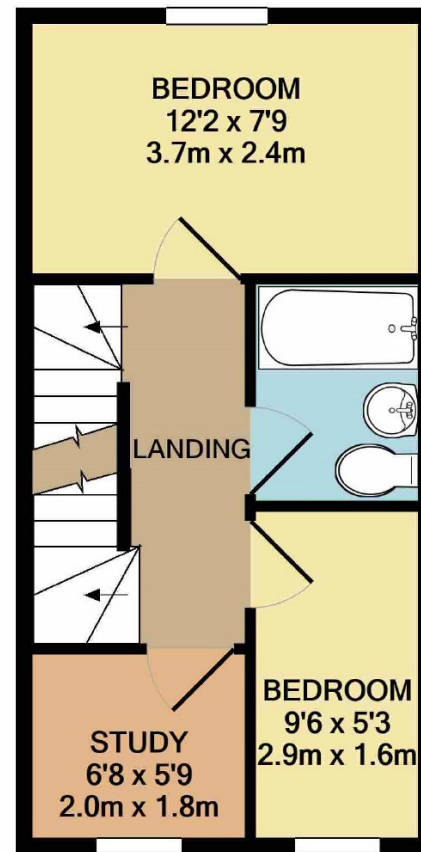

1ST FLOOR

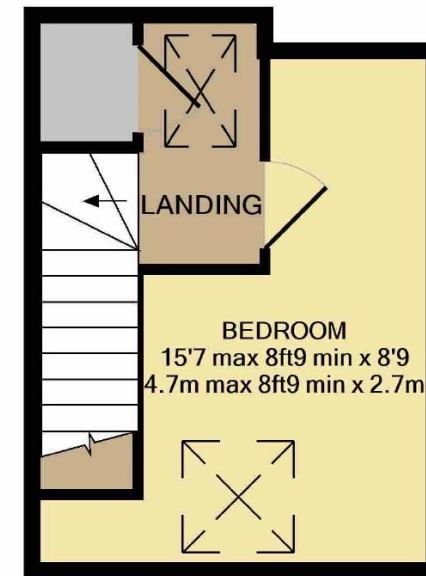

2ND FLOOR

Whilst every attempt has been made to ensure the accuracy of the floor plan contained here, measurements of doors, windows, rooms and any other items are approximate and no responsibility is taken for any error, omission, or mis-statement. This plan is for illustrative purposes only and should be used as such by any prospective purchaser. The services, systems and appliances shown have not been tested and no guarantee as to their operability or efficiency can be given
Made with Metropix ©2020



These particulars are believed to be accurate but they are not guaranteed and do not form a contract. Neither Jordan Fishwick nor the vendor or lessor accept any responsibility in respect of these particulars, which are not intended to be statements or representations of fact and any intending purchaser or lessee must satisfy himself by inspection or otherwise as to the correctness of each of the statements contained in these particulars. Any floorplans on this brochure are for illustrative purposes only and are not necessarily to scale.

Offices also at: Wilmslow, Macclesfield, Hale, Sale, Chorlton, Glossop, Manchester & Salford

14 Market Street, Disley, Cheshire, SK12 2AA

01663 76 78 78

disley@jordanfishwick.co.uk