



Sunningdale Road, Hessle, HU13

£144,950



 3  1  2  E Band: C

- Semi-Detached House
- In Need of Modernisation
- Three Bedrooms & Two Reception Rooms
- G.C.H. & Majority PVCu D.G.
- Spacious Rear Garden
- Off-Street Parking
- Popular Hessle Location
- Chain Free!





Offered with no chain, this traditional and well-loved semi-detached house has been this family's home since 1963! The property, which is in need of modernisation, is situated on Sunningdale Road opposite Gisburn Road and on the '66' bus route. so it is within easy reach of Hessle centre, Anlaby, Hull, Beverley, the Humber Bridge, and the A63/M62 corridor. The house itself is set out over two floors. The ground floor comprises an entrance hall, lounge, dining room, kitchen, rear lobby, WC, and coal store. The first floor comprises a landing, three bedrooms, and a bathroom. The house is fitted with gas central heating and the majority of the windows are PVCu double glazed. To the front of the property is a shared driveway access with the potential for off-street parking to the front, whilst to the rear is a hard-standing and a garden laid mainly to lawn with planted borders. This well-loved house in a popular Hessle location has enormous potential, and it's chain-free, so contact Hudson Property now to book your viewing!



Fixtures & Fittings: All carpets, curtains, blinds and light fittings are included in the sale.





Ground Floor

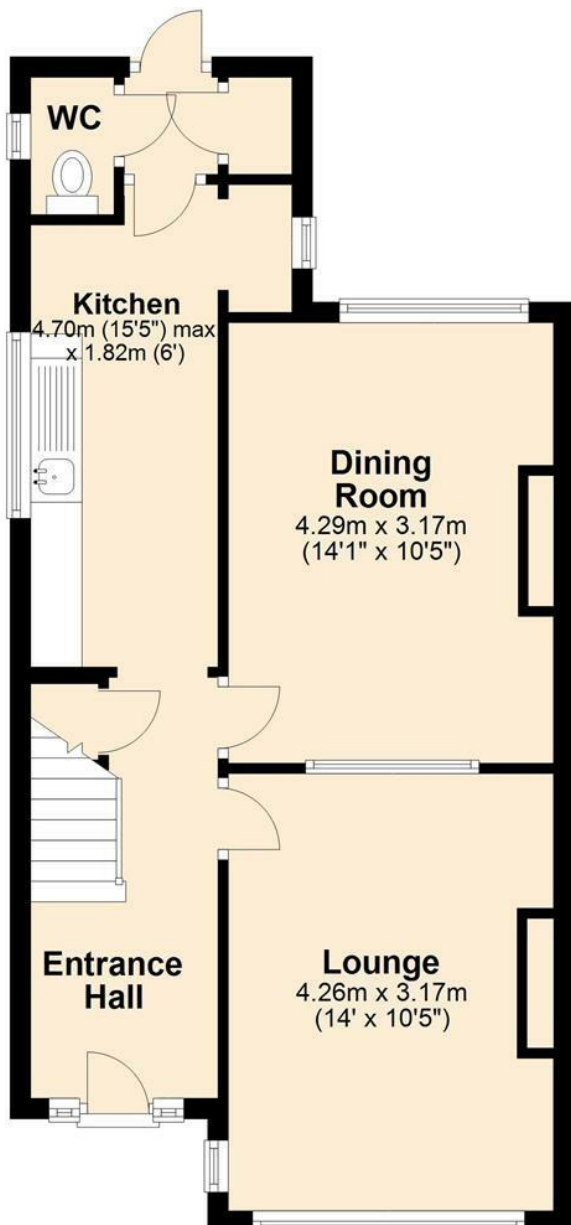

First Floor

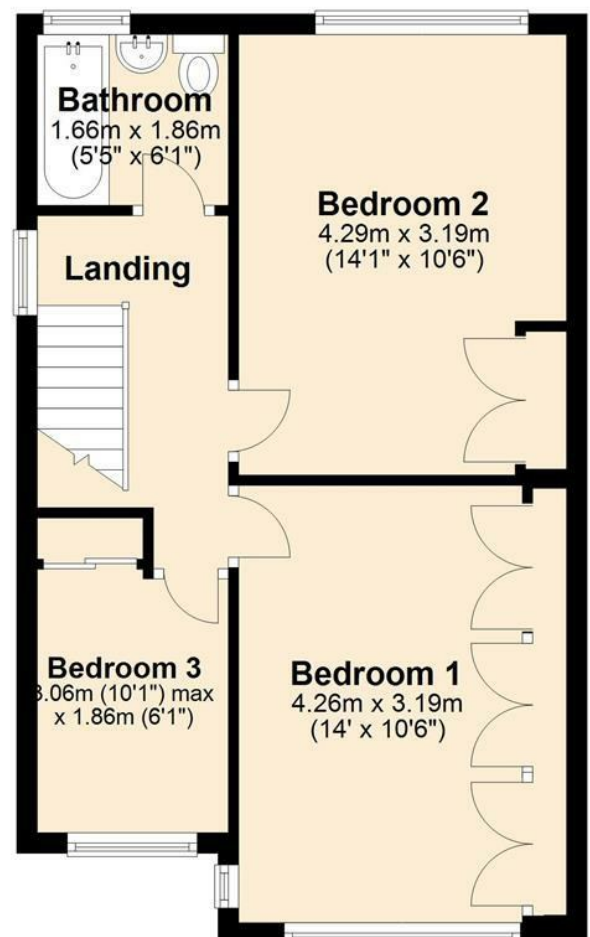

MEASUREMENTS: Please note that all measurements are approximate. **STAMP DUTY:** Many property purchases are subject to Stamp Duty Land Tax, and the rules governing stamp duty and the levies imposed are complex. HM Revenue & Customs have an online calculator to assist you in calculating your stamp duty liability (<https://www.gov.uk/stamp-duty-land-tax>) but please always check with your solicitor. **COPYRIGHT:** All photographs and images are the exclusive property of Hudson Property Angels Limited and are protected by copyright law. The images may not be reproduced, copied, transmitted or manipulated without the written consent of a director of Hudson Property Angels Limited.