



Front Street, Westgate, DL13 1SD  
 2 Bed - Cottage - Terraced  
 £105,000

**ROBINSONS**  
 SALES • LETTINGS • AUCTIONS • SURVEYS



**\*\*STUNNING COTTAGE\*\*MANY TRADITIONAL FEATURES\*\*TWO DOUBLE BEDROOMS\*\*POPULAR VILLAGE LOCATION\*\*NO ONWARD CHAIN\*\*VIEWING HIGHLY RECOMMENDED\*\***

This stone built very well presented two bedroom cottage is located in the popular village of Westgate in Upper Weardale, and benefits from having many traditional features, including open fire, stone flooring, wooden beams and pleasant countryside views.

The property is offered to the market with no onward chain, warmed by solid fuel and double glazing, and the internal floor plan comprises of lounge, kitchen, large walk in storage room.

To the first floor there is a bedroom and a bathroom while a further staircase leads to the second floor where there is a further bedroom.

Outside there are gardens to front and rear which will be pleasant in the summer months.

Westgate has the benefit of a village public house and is on a bus route giving access to other local villages, the closest being ST Johns Chapel, where there are is a wider range of amenities including village convenience store, cafe and two pubs.

We feel an internal viewing is a must to fully appreciate this property, please contact Robinsons today to arrange yours.















# OUR SERVICES

Mortgage Advice

Conveyancing

Surveys and EPCs

Property Auctions

Lettings and Management

Strategic Marketing Plan

Dedicated Property Manager

## Front Street Westgate

Approximate Gross Internal Area  
923 sq ft - 86 sq m

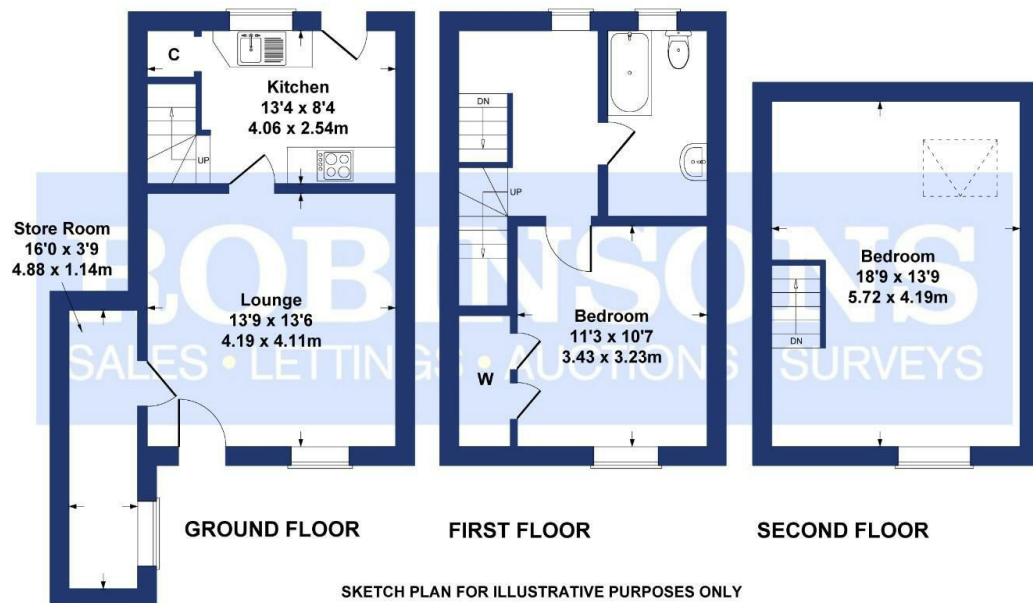

SKETCH PLAN FOR ILLUSTRATIVE PURPOSES ONLY

All measurements walls, doors, windows, fittings and appliances, their sizes and locations, are approximate only. They cannot be regarded as being a representation by the seller, nor their agent.

Produced by Potterplans Ltd. 2020

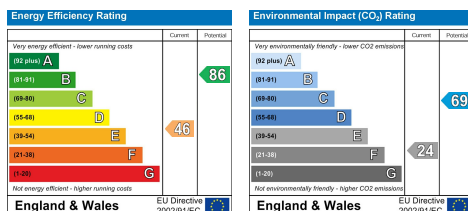

### DURHAM SALES & LETTINGS OFFICE

DURHAM CITY  
1 Old Elvet  
DH1 3HI

T: 0191 386 2777 (Sales)  
T: 0191 383 9994 (option1) (Lettings)  
E: info@robinsonsdurham.co.uk

### CHESTER-LE-STREET

45 Front Street  
DH3 3BH  
T: 0191 387 3000  
E: info@robinsonscs.co.uk

### SPENNYMOOR

11 Cheapside  
DH16 6QE  
T: 01388 420444  
E: info@robinsonsspenny Moor.co.uk

### DARLINGTON

7 Duke Street  
DL3 7RX  
T: 01325 484440  
E: info@robinsonsdarlington.co.uk

### MIDDLESBROUGH

26 Stokesley Road  
TS7 8DX  
T: 01642 313666  
E: info@robinsonsmiddlesbrough.co.uk

### BISHOP AUCKLAND

120 Newgate Street  
DL14 7EH  
T: 01388 458111  
E: info@robinsonsbishop.co.uk

### STOCKTON

21 Bishop Street  
TS18 1SY  
T: 01642 607555  
E: info@robinsonstockton.co.uk

### REGIONAL LETTING & MANAGEMENT CENTRE

DURHAM CITY  
14 West Terrace  
DH6 4HP

T: 0191 383 9994 (option 2)  
T: 0191 383 9994 (option1) (Lettings)  
E: admin@robinsonslettings.co.uk

### CROOK

Royal Corner  
DL15 9UA  
T: 01388 763477  
E: info@robinsonscrook.co.uk

### SEDFIELD

3 High Street  
TS21 2AU  
T: 01740 621777  
E: info@robinsonssedfield.co.uk

### HARTLEPOOL

106 York Road  
TS26 9DE  
T: 01429 891100  
E: info@robinsonshartlepool.co.uk

### INGLEBY BARWICK

Barwick Lodge  
TS17 0RH  
T: 01642 762944  
E: info@robinsonsbarnwick.co.uk

Every care has been taken with the preparation of these particulars, but they are for general guidance only and complete accuracy cannot be guaranteed. If there is any point, which is of particular importance please ask or professional verification should be sought. All dimensions are approximate. The mention of fixtures, fittings &/or appliances does not imply they are in full efficient working order. Photographs are provided for general information and it cannot be inferred that any item shown is included in the sale. These particulars do not constitute a contract or part of a contract.

Robinsons can recommend financial services, surveying and conveyancing services to sellers and buyers. Robinsons staff may benefit from referral incentives relating to these services.



# ROBINSONS

SALES • LETTINGS • AUCTIONS

Royal Corner, Crook, County Durham, | Tel: 01388763477 | info@robinsonscrook.co.uk

www.robinsonsestateagents.co.uk