



**MILES ESTATE AGENTS**

**1 Grenville View Cotford St. Luke  
Taunton TA4 1JH**



A well presented and spacious 3 storey town house with 5 bedrooms, 2 bathrooms and enclosed low maintenance garden. Garage with off road parking - early viewing recommended.





## Features

- Entrance Hall
- Spacious Lounge
- Dining Room
- Kitchen
- Cloakroom
- 4 Double Bedrooms (Master En Suite)
- Further Single Bedroom / Nursery
- Family Bathroom
- Enclosed Garden
- Garage & Off Road Parking
- Council Tax Band E







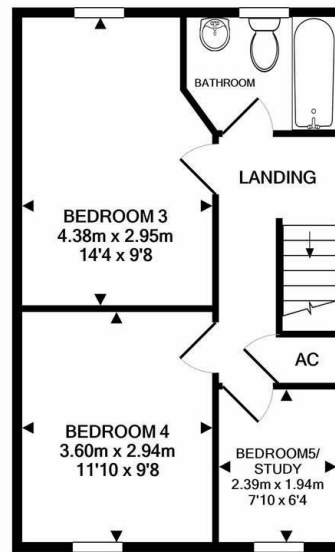

TOTAL APPROX. FLOOR AREA 115.9 SQ.M. (1247 SQ.FT.)

Whilst every attempt has been made to ensure the accuracy of the floor plan contained here, measurements of doors, windows, rooms and any other items are approximate and no responsibility is taken for any error, omission, or mis-statement. This plan is for illustrative purposes only and should be used as such by any prospective purchaser. The services, systems and appliances shown have not been tested and no guarantee as to their operability or efficiency can be given

Made with Metropix ©2020



[www.milesestateagents.co.uk](http://www.milesestateagents.co.uk)

