



MILES ESTATE AGENTS

21 Ellis Grove Norton Fitzwarren
Taunton TA2 6SY



A well presented and extended modern 4 bedroom detached house with west facing garden overlooking fields and super log cabin. Conservatory, garage, parking and energy saving solar panels - early viewing highly recommended.





Features

- Entrance Hall
- Good Size Sitting Room
- Dining Room
- Refitted Kitchen
- Conservatory
- Refitted Cloakroom
- 4 Bedrooms
- Refitted Bathroom
- Fully Serviced & Insulated Log Cabin
- Solar Panels for Energy Efficiency
- West Facing Garden Overlooking Fields
- Garage & Off Road Parking
- Council Tax Band D







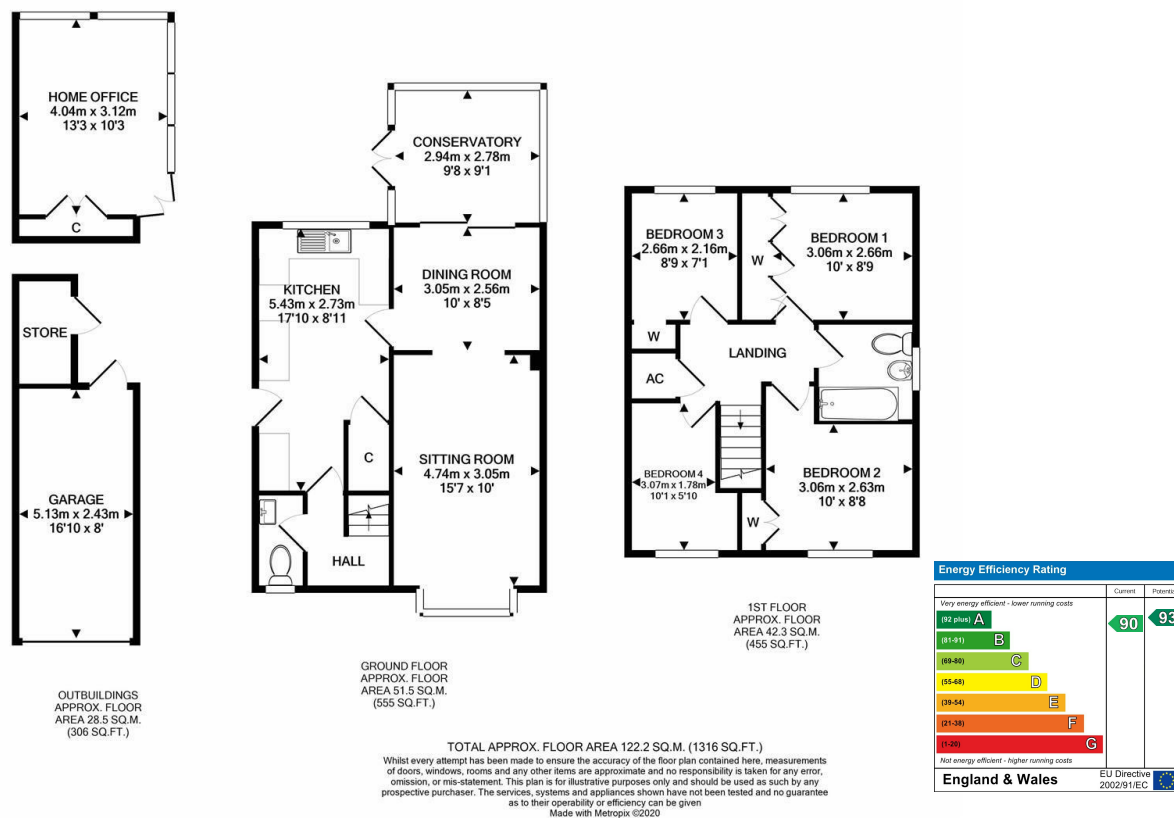

Viewings strictly through the selling agents:

Miles Estate Agents

2 Piffin Lane, Bishops Lydeard, Taunton,
Somerset, TA4 3AS

Tel: 01823 470 500

lydeard@milesestateagents.co.uk

www.milesestateagents.co.uk



MILES ESTATE AGENTS

rightmove

Zoopla.co.uk

onTheMarket.com

