



MILES ESTATE AGENTS

1 Halse Manor Halse
Taunton TA4 3AE



A rare opportunity to purchase a spacious and well proportioned section of this glorious Grade II Listed Manor House, peacefully situated amidst well tended grounds in the heart of this sought after village. Fabulous Sitting Room with retained period features, 4 bedrooms, 2 bathrooms, useful cellar and carport. Scope for cosmetic improvement to create an elegant and stylish country retreat. Leasehold for 990 years from 01/06/89. Service charge £4085.92 pa Early viewing highly recommended.





Features

- Entrance Hall
- Fabulous Sitting Room with Retained Period Features
- Kitchen/Breakfast Room
- Cloakroom
- 4 Bedrooms (Master En Suite)
- Family Bathroom
- Store & Useful Cellar
- Carport & Outside Store
- Private Terrace
- Approx 4 Acres Well Tended Communal Gardens
- Leasehold for 990 Years From 01/06/89
- Service Charge £4085.92 pa







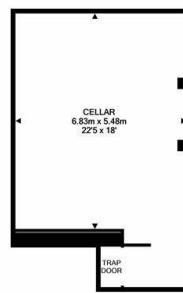

CELLAR
APPROX. FLOOR
AREA 43.3 SQ.M.
(460 SQ.FT.)

TOTAL APPROX. FLOOR AREA 181.7 SQ.M. (1956 SQ.FT.)

Whilst every attempt has been made to ensure the accuracy of the floor plan contained here, measurements of doors, windows, rooms and any other items are approximate and no responsibility is taken for any error, omission, or misstatement. This plan is for illustrative purposes only and should be used as such by any prospective purchaser. The services, systems and appliances shown have not been tested and no guarantee is given to their operation or working order (as given).
Made with Metaplan 02/2020

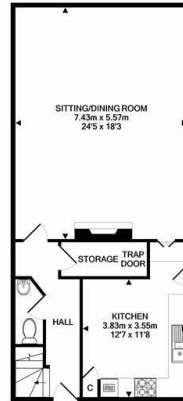

GROUND FLOOR
APPROX. FLOOR
AREA 69.3 SQ.M.
(746 SQ.FT.)

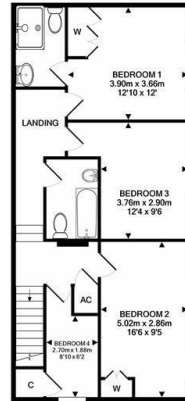

FIRST FLOOR
APPROX. FLOOR
AREA 69.1 SQ.M.
(744 SQ.FT.)



Viewings strictly through the selling agents:

Miles Estate Agents

2 Piffin Lane, Bishops Lydeard, Taunton,
Somerset, TA4 3AS

Tel: 01823 470 500

lydeard@milesestateagents.co.uk

www.milesestateagents.co.uk



rightmove

Zoopla.co.uk

onTheMarket.com

MILES ESTATE AGENTS

