



Beechcroft Avenue, London
£3,000 pcm %tenure%

*** SOLE AGENTS *** HIGH SPECIFICATION ***

Mile are pleased to offer this modern three bedroom flat to rent! This incredible property consists of three double bedrooms and three bathrooms (two of which are En-suite), a family bathroom, a large reception room and fully fitted kitchen. This superb apartment also comes with an Air-conditioning unit in each room, two kitchen sinks perfect for a kosher kitchen and off street parking for one car. The property is located in a highly sought after location 5 min walk from Golders Green station and amenities. It is also a stones throw from local synagogues in the area! This flat is AVAILABLE NOW AND MUST BE SEEN TO AVOID DISAPPOINTMENT!!!

- MODERN
- AIR CONDITIONED
- THREE DOUBLE BEDROOMS
- THREE BATHROOMS
- HIGH SPECIFICATION
- TWO KITCHEN SINKS
- HIGHLY SOUGHT AFTER LOCATION
- CLOSE TO STATION AND SHOPS
- Available NOW!!!!
- MUST BE SEEN!!!

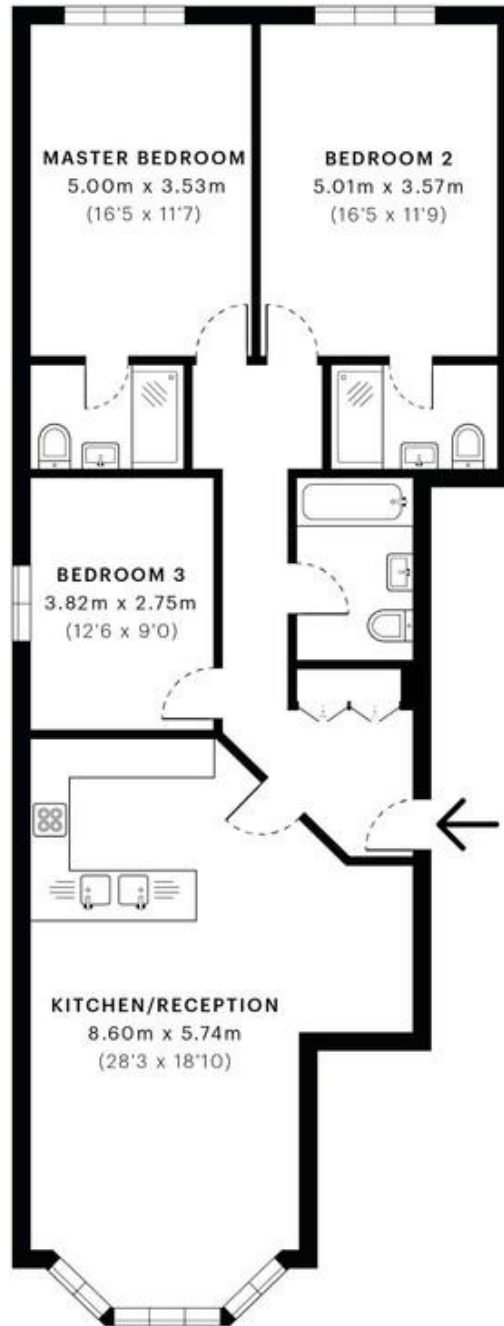

— Ground Floor

GROSS INTERNAL AREA (GIA)
The footprint of the property.
112.2 Sqm / 1208.1 Sqft

NET INTERNAL AREA (NIA)
Excludes walls and external features.
Includes washrooms, restricted head
107.3 Sqm / 1155.4 Sqft

EXTERNAL STRUCTURAL FEATURES
Balconies, terraces, verandas etc.
0.0 Sqm / 0.0 Sqft

RESTRICTED HEAD HEIGHT
Limited use area under 1.5m
0.0 Sqm / 0.0 Sqft