



MILES ESTATE AGENTS

**Cranleigh, 72 Tower Hill,
Williton, Somerset TA4 4JR**



A superb extended 3 double bedroom detached house, professionally modernised and updated to exacting standards in this prestigious location on the edge of the thriving town of Williton. Spacious sitting room with woodburning stove, lovely conservatory, refitted kitchen, bathroom and brand new en suite. Fabulous gardens of around 0.28 acre backing on to fields, tandem double garage and lots of parking. Early viewing highly recommended and sure to impress!





Features:

- Entrance Hall
- Spacious Sitting Room with Woodburning Stove
- Separate Dining Room
- Refitted and Remodelled Kitchen
- Lovely Conservatory
- Cloakroom
- Utility
- Generous Master Bedroom with En Suite
- 2 Further Double Bedrooms
- Refitted Family Bathroom
- Gardens of 0.22 Acre backing onto Fields
- Tandem Double Garage
- Parking for Several Cars









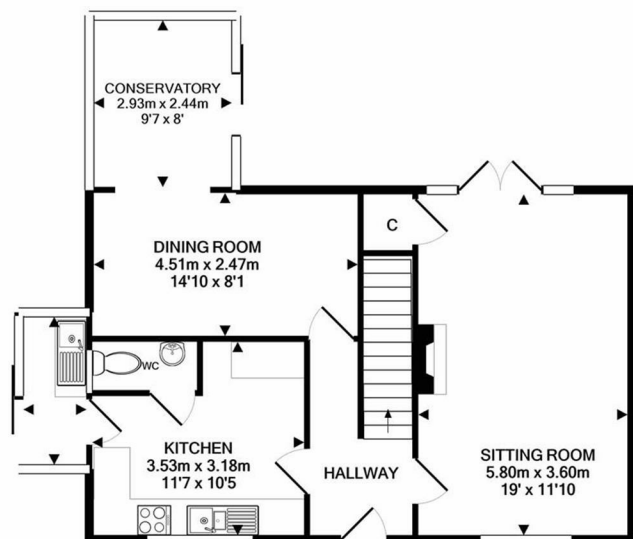
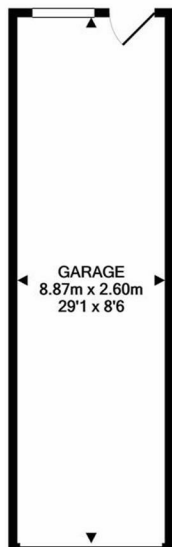

GROUND FLOOR
APPROX. FLOOR
AREA 85.5 SQ.M.
(920 SQ.FT.)

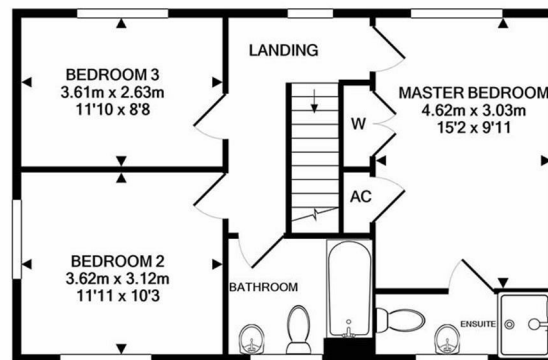

1ST FLOOR
APPROX. FLOOR
AREA 51.1 SQ.M.
(550 SQ.FT.)

TOTAL APPROX. FLOOR AREA 136.5 SQ.M. (1470 SQ.FT.)

Whilst every attempt has been made to ensure the accuracy of the floor plan contained here, measurements of doors, windows, rooms and any other items are approximate and no responsibility is taken for any error, omission, or mis-statement. This plan is for illustrative purposes only and should be used as such by any prospective purchaser. The services, systems and appliances shown have not been tested and no guarantee as to their operability or efficiency can be given
Made with Metropix ©2020

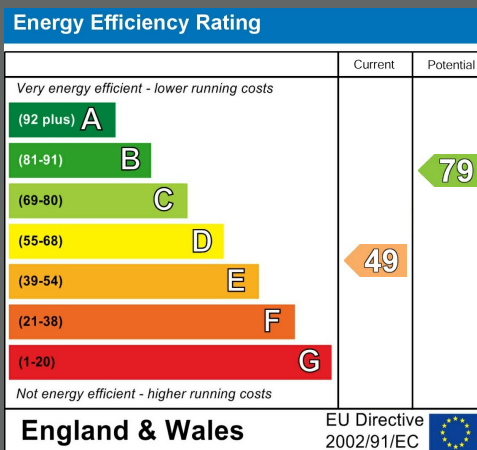

MILES ESTATE AGENTS



Viewings strictly through the selling agents:

Miles Estate Agents

2 Piffin Lane, Bishops Lydeard, Taunton,

Somerset, TA4 3AS

Tel: 01823 470 500

lydeard@milesestateagents.co.uk

www.milesestateagents.co.uk

rightmove

Zoopla.co.uk

OnTheMarket.com



BEST

ESTATE AGENT GUIDE
2019 : EXCEPTIONAL

SALES

