



Croxley Road, Maida Vale, London

2nd floor flat

Asking Price Of: £249,950

Set on the peaceful Croxley Road, this 2nd floor studio apartment offers the potential for a great investment. In need of a full renovation and updating, this is a unique opportunity to truly personalise and outfit a home to the next owner's needs. With the high demand in rental options in the local area, this apartment offers a solid long-term investment option for landlords as well as people looking for their future home. This property has come to the market chain free and early viewings are strongly recommended.



- Studio apartment
- Separate bathroom
- Potential to renovate
- Easy access to local tube stations
- Near to Queens Park

Situated between Queens Park and Maida Vale stations, this apartment offers easy transport links around London as well as great access to a wide variety of local amenities, cafes, bars and restaurants. With Portobello market a short walk away and a number of nearby green spaces, this flat makes a fantastic base from which to explore.

Croxley Road, W9

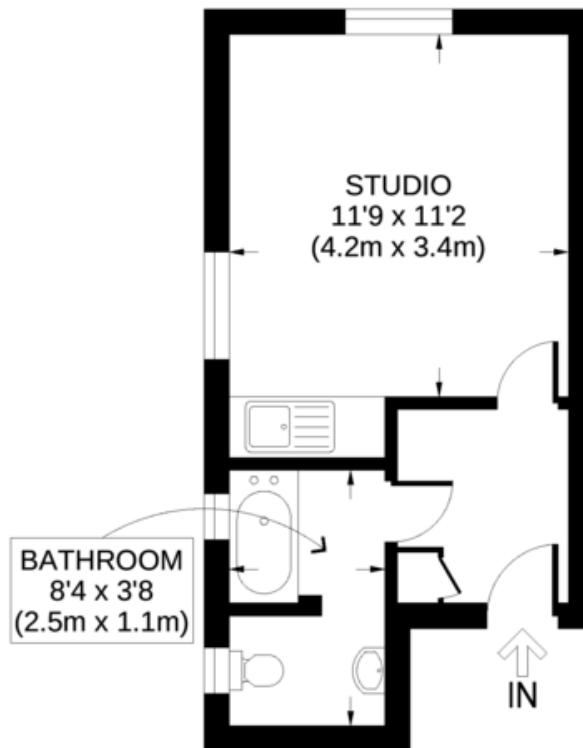

SECOND FLOOR
GROSS INTERNAL
FLOOR AREA 226 SQ FT

APPROX. GROSS INTERNAL FLOOR AREA: 226 SQ FT /21 SQM

Ref:

Copyright **Lumiere** digital

Disclaimer: Floor plan measurements are approximate and are for illustrative purposes only. While we do not doubt the floor plan accuracy and completeness, you or your advisors should conduct a careful, independent investigation of the property in respect of monetary valuation

Contact us

20 Great Western Road

London

W9 3NN

T: 020 7286 5757

E: sales@westways.co.uk



Westways



Tenure: Leasehold
Lease Remaining: 85

Gross Internal Area: 226 sqft

Local Authority: Westminster City Council
Council Tax Band: C

EPC Rating: TBC

In accordance with the 1993 Misdescriptions Act: The agent has not tested any apparatus, equipment, fixtures, fittings or services and se cannot verify they are in working order. Neither has the Agent checked the legal documents to verify the Leasehold/Freehold status of the property. The buyer is advised to obtain verification from their solicitor or surveyor. Also photographs are for illustration only and may depict items which are not for sale or included in the sale of the property. All sizes are approximate.

