



**SALES**

**LETTINGS**

**MANAGEMENT**

[chiswick@tatepartnership.co.uk](mailto:chiswick@tatepartnership.co.uk)

**020 8996 0000**

**TATEPARTNERSHIP.CO.UK**



**Ravensmede Way, Chiswick**

**£1,850 pcm**

This is a two bedroom ground floor apartment, within a purpose build block, in a centrally located low rise development. At 557sq/ft., the entrance hall has a deep storage cupboard, bright living room with separate kitchen, main double bedroom, second bedroom (single) suited to "work from home" office or infant bedroom, modern bathroom with shower over bath. Outside are well kept communal gardens and Private Parking for residents only, on FCFS basis. Ravensmede Way is just off Chiswick High Road. On your doorstep is central shopping, dining and transport facilities. Approx., 5 mins walk from Stamford Brook tube station and a couple of minutes drive to the A4(M), going East into Kensington & Knightsbridge and out West to Heathrow. Available mid-February. Part furnished.

# Ravensmede Way, Chiswick

## Floor Plan

Approximate gross internal area  
52 sq m / 557 sq ft

Approximate Gross Internal Area = 51.8 sq m / 557 sq ft

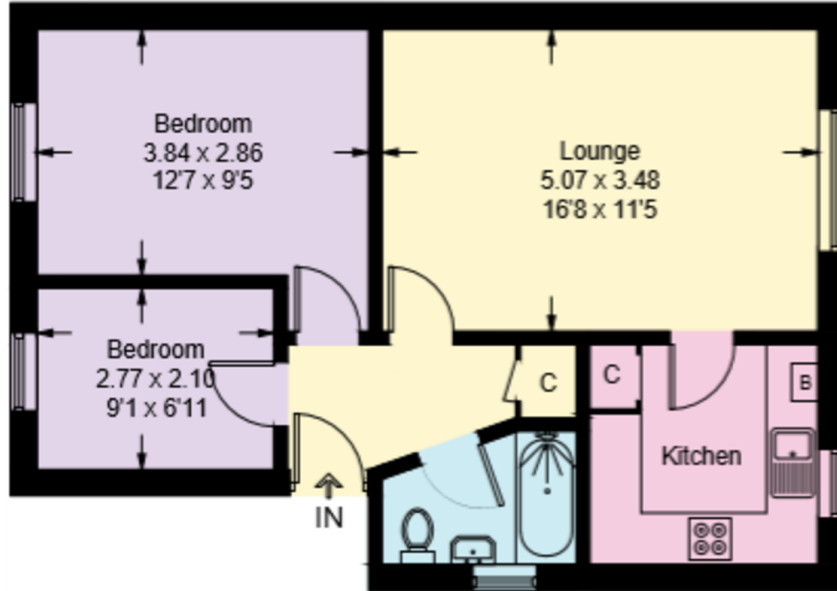

## EPC

### Energy Efficiency Rating

Very energy efficient - lower running costs

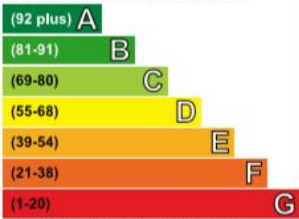

Current	Potential
72	77