

92 Dolphin Quays
The Quay, Poole, Dorset
BH15 1HH



LLOYDS
PROPERTY GROUP

92 Dolphin Quays

The Quay

Poole

Dorset

BH15 1HH

£375,000

With far reaching aaviews of Sandbanks and Studland - A large 2 double bedroom 5th floor apartment for sale in the desired Dolphin Quays development, situated on Poole Quay.

There is a 24 hour concierge service at the main entrance to Dolphin Quays. The apartment has an allocated parking space in the gated car park located to the rear of the development.





The apartment has a high end finish throughout, with extensive storage space and high quality appliances from Miele in the kitchen.

The kitchen/living room boasts views of the Purbeck Hills and Sandbanks in the distance, with access onto the balcony.

The master suite measures over 23ft in length, has a built in double wardrobe and boasts a large luxurious en-suite with both shower and bath facilities. The second bedroom also has access to the balcony.

The family bathroom is similarly fitted with an equally high quality suite. From the hallway there are also 3 separate cupboards providing vital storage space.

Council Tax Band D: £1517.85 payable per annum.

Pets are allowed (subject to permission)

Leasehold property – Ground Rent £250.00 every 6 months and service charge £1690.84 every 6 months (service charge includes but is not limited to Buildings insurance, lift maintenance, communal area cleaning and utilities, window cleaning and 24/7 concierge service)

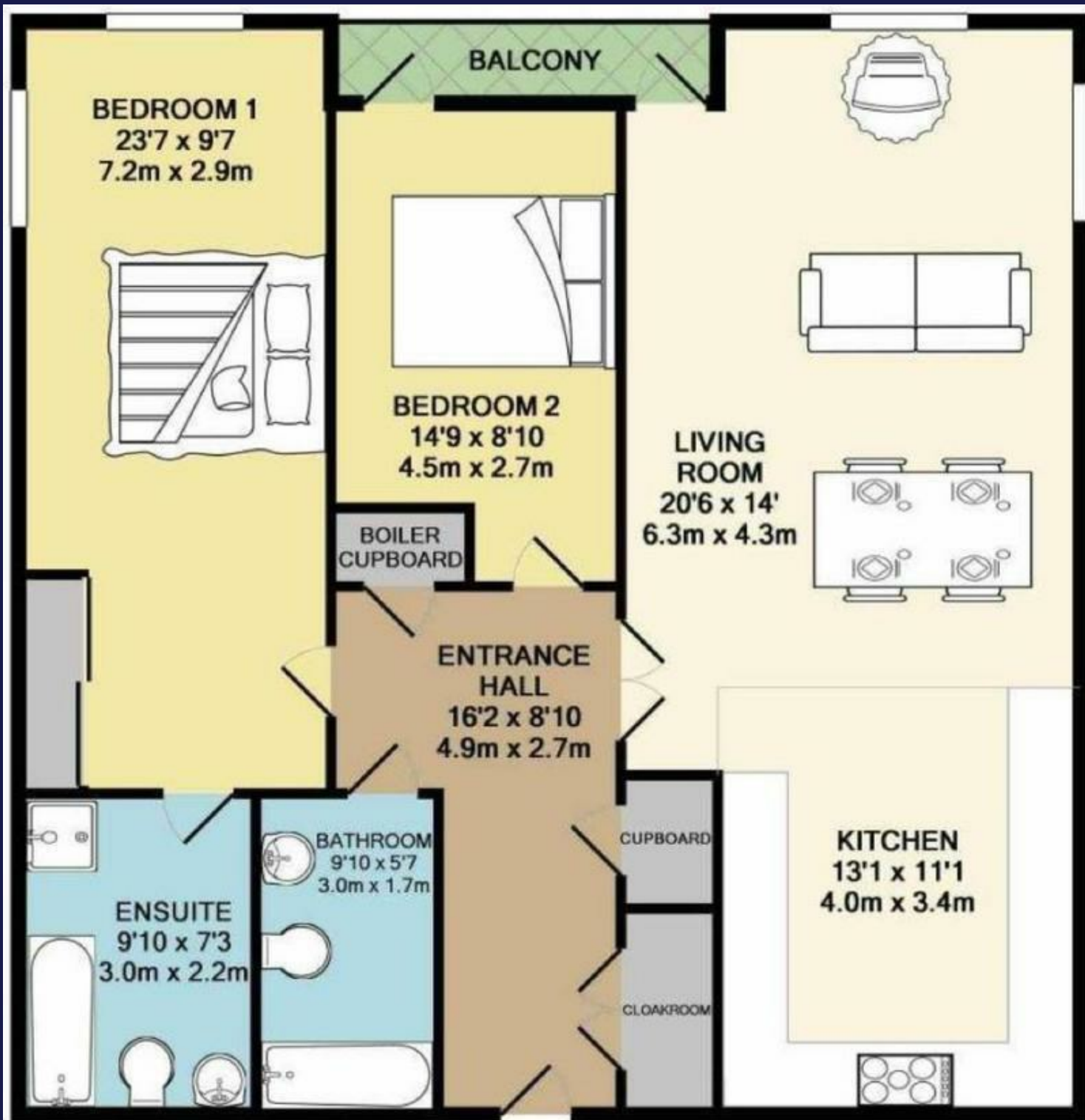

TOTAL APPROX. FLOOR AREA 1054 SQ.FT. (97.9 SQ.M.)

Whilst every attempt has been made to ensure the accuracy of the floor plan contained here, measurements of doors, windows, rooms and any other items are approximate and no responsibility is taken for any error, omission, or mis-statement. This plan is for illustrative purposes only and should be used as such by any prospective purchaser. The services, systems and appliances shown have not been tested and no guarantee as to their operability or efficiency can be given

Made with Metropix ©2017

Lloyds Property Group, 264 Sandbanks Rd, Lilliput, Poole, BH14 8HA
01202 708044 | enquiries@lloydspropertygroup.com | www.lloydspropertygroup.com

Ref: 3306

Important Notice

Lloyds, their clients and any joint agents give notice that:

1. They have no authority to make or give any representation or warranties in relation to the property. These particulars do not form part of an offer or contract and must not be relied upon as statements or representations of fact.

2. Any areas, measurements or distances are approximate. The text, photographs and plans are for guidance only and are not necessarily comprehensive. It should not be assumed that the property has all necessary planning, building regulation or other consents and Lloyds have not tested on any services, equipment or facilities. Purchasers must satisfy themselves by inspection or otherwise.