

19 School Close, Northfield, Birmingham | **Guide Price** £215,000
Modern Three Bedroomed Town House

Features:

- Three Bedrooms
- Master Bedroom with En-Suite
- Lounge
- Kitchen/Diner
- Rear Garden
- Garage & Driveway

Summary:

A well presented three bed roomed town house, offered with a modern kitchen/diner, an en-suite to master bedroom, garage and driveway providing off road parking, situated in Northfield, Birmingham.

Description:

The accommodation split over three floors, in brief, features:- Driveway providing off Road Parking, Hallway, WC, Garage, Bedroom, Stairs to First Floor, Modern Kitchen/Diner with Integrated Oven, Hob and Extractor and Door to Outside Terrace Area, Lounge with Door Overlooking Rear Garden, Stairs to Second Floor, Master Bedroom with En-suite Shower Room, Bedroom Three and Family Bathroom.

Outside:

Outside, the property enjoys a neatly presented stone chipped rear garden with a decked patio area.

Location:

Northfield is a vibrant town offering a number of shopping and eating facilities, plus easy access for commuters into Birmingham City Centre. No more than 1.5 miles away (a 15-20 minute walk) is Longbridge Train Station and the recently regenerated Longbridge Town Centre Development (former MG Rover car plant), home to the largest Marks and Spencers in the Midlands.



Garage:
27' 6" x 8' 11" (8.40m x 2.73m) max

Hall

WC
5' 8" x 3' 1" (1.74m x 0.95m)

Bedroom Three:
12' 3" x 9' 1" (3.75m x 2.79m) max

Stairs To First Floor Landing

Lounge:
15' 10" x 11' 2" (4.84m x 3.42m) max

Kitchen/Diner:
16' 9" x 9' 6" (5.13m x 2.90m) max

Balcony:
5' 7" x 16' 4" (1.71m x 4.99m)

Stairs To Second Floor Landing

Master Bedroom:
12' 4" x 12' 10" (3.76m x 3.92m) max

En Suite:
4' 5" x 8' 5" (1.35m x 2.58m)

Bedroom Two:
9' 4" x 11' 0" (2.87m x 3.36m) max

Bathroom:
6' 1" x 6' 4" (1.87m x 1.94m)

EPC: TBC
Council Tax Band: D
Tenure: Freehold

For more information on School Close or to arrange a viewing, please call the Rubery Office on 0121 453 4349

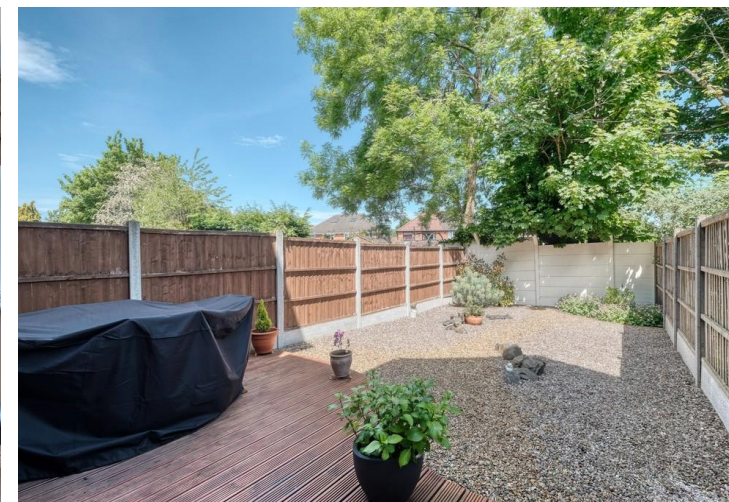

School Close, Northfield

Ground Floor

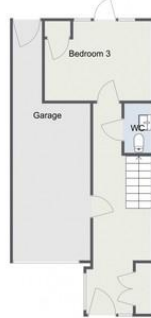

First Floor



Second Floor



Total Area Excluding Balcony Approx
124.1 sq m
1335.8 sq ft

For illustrative purposes only. Decorative finishes, fixtures & fittings do not represent the current state of the property. Measurements are approximate & not to scale. Floor Plans made using RoomSketcher.

School Close, Northfield

Ground Floor



First Floor



Second Floor



Total Area Excluding Balcony Approx
124.1 sq m
1335.8 sq ft

For illustrative purposes only. Decorative finishes, fixtures & fittings do not represent the current state of the property. Measurements are approximate & not to scale. Floor Plans made using RoomSketcher.

Please read the following: These particulars are for general guidance only and are based on information supplied and approved by the seller. Complete accuracy cannot be guaranteed and may be subject to errors and/or omissions. They do not constitute a contract or part of a contract in any way. We are not surveyors or conveyancing experts therefore we cannot and do not comment on the condition, issues relating to title or other legal issues that may affect this property. Interested parties should employ their own professionals to make enquiries before carrying out any transactional decisions. Photographs are provided for illustrative purposes only and the items shown in these are not necessarily included in the sale, unless specifically stated. The mention of any fixtures, fittings and/or appliances does not imply that they are in full efficient working order and they have not been tested. All dimensions are approximate. We are not liable for any loss arising from the use of these details.