

Vacant Freehold Approximately 1,017 sq ft
Longhill Road, Catford SE6 1TZ
Of interest to owner occupiers, investors and developers



Guide Price £310,000 PLUS

Subject to Contract

SOLD STC

Location

The Property is situated in Catford, within the London Borough of Lewisham, in a well-established residential area, a short distance from Forster Memorial Park. The nearest station is Bellingham Station, about 1.5km to the west.

Longhill Road is a quiet no through road off Hazelbank Road, 2km south of Catford town centre, in a well-regarded family friendly residential area, convenient for a number of nearby outstanding and good Ofsted rated schools.

Description and Accommodation

Offering front and rear gardens, with off road parking at the rear. There are two reception rooms with an open plan kitchen. With generous accommodation with two double bedrooms. With a detached double garage.

- 3 Bedrooms
- 2 Reception rooms
- Kitchen area
- Bathroom with WC
- Double garage



Ground Floor

Approx. 53.7 sq. metres (578.1 sq. feet)

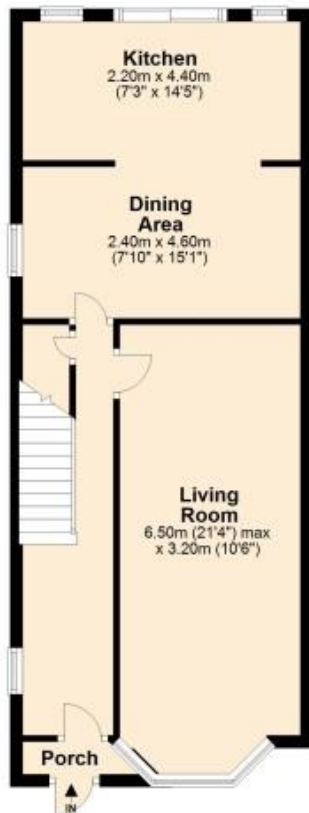

First Floor

Approx. 40.8 sq. metres (439.4 sq. feet)

Price Taylor

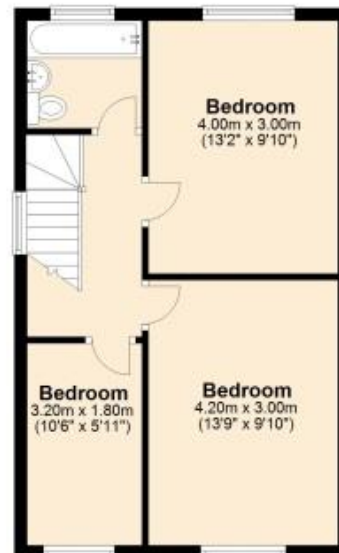

Total area: approx. 94.5 sq. metres (1017.5 sq. feet)

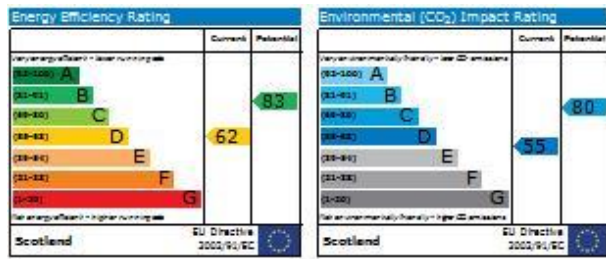

Viewing

Strictly by appointment through the Sole Agents:

Price Taylor LLP

P.Mellors Puccinelli MRICS

p.puccinelli@pricetaylor.com

T. 0207 704 8512

[Ref: F16627]