



11 Moon Street | Sutton Harbour | Plymouth | PL4 0AL

Guide £110,000-£120,000

A modern purpose built apartment.

This second floor flat is situated within the area of Sutton Harbour and is within a short walk of the City Centre, the historic Barbican and Plymouth Hoe.

Accommodation briefly comprises; entrance hall, open plan living with Juliet balcony, generous double bedroom and family bathroom. The property is located within a close proximity of Drake Circus Shopping Centre, the marina and all local facilities. Making this an ideal main residence, holiday home or indeed an investment property with a yield of 7.4%.

- Purpose Built Apartment
- Second Floor
- Large Open Plan Living Room
- Juliet Balcony
- Spacious Bedroom
- Close to Drake Circus
- Within a short walk of all facilities

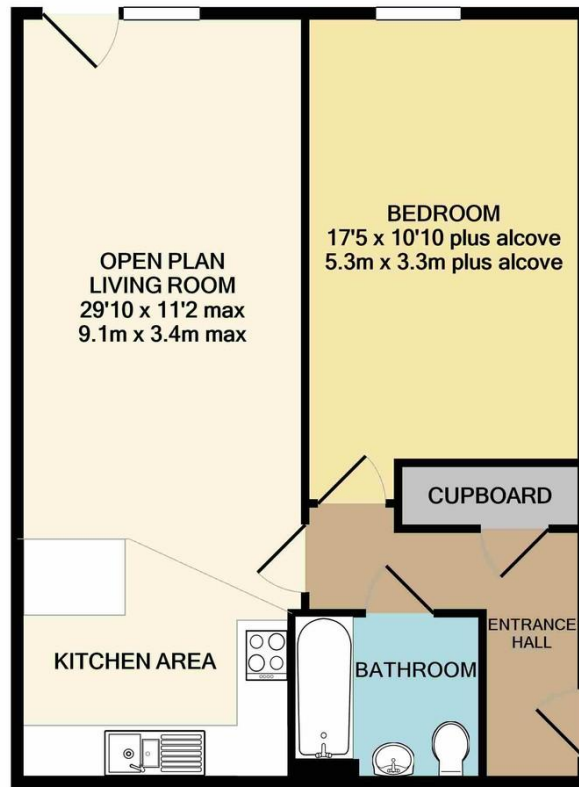

TOTAL APPROX. FLOOR AREA 655 SQ.FT. (60.8 SQ.M.)

Whilst every attempt has been made to ensure the accuracy of the floor plan contained here, measurements of doors, windows, rooms and any other items are approximate and no responsibility is taken for any error, omission, or mis-statement. This plan is for illustrative purposes only and should be used as such by any prospective purchaser. The services, systems and appliances shown have not been tested and no guarantee as to their operability or efficiency can be given
Made with Metropix ©2020

Contact Details

48 Ebrington Street
Plymouth
Devon
PL4 9AD

www.athomelettings.com
info@athomeproperty.co.uk
01752 777070

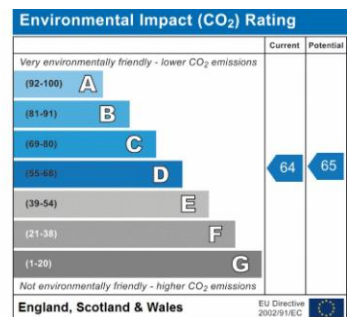
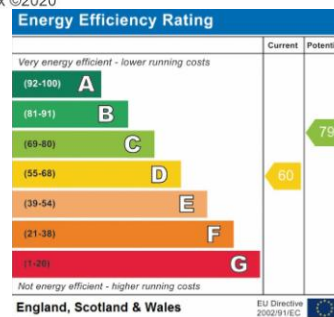

Agents Note: Whilst every care has been taken to prepare these sales particulars, they are for guidance purposes only. All measurements are approximate are for general guidance purposes only and whilst every care has been taken to ensure their accuracy, they should not be relied upon and potential buyers are advised to recheck the measurements