

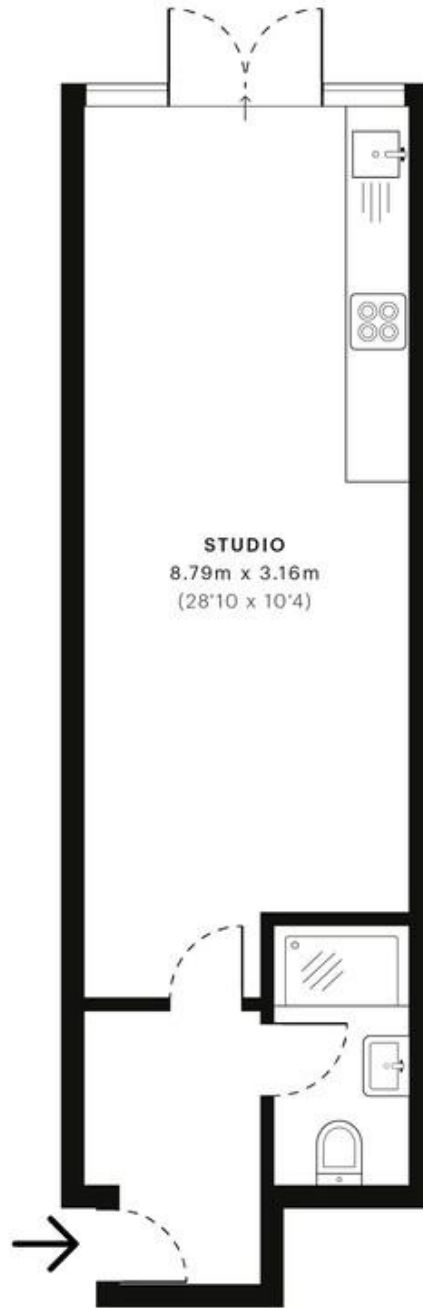

Beechcroft Avenue Avenue, London
£1,200 pcm

Mile are pleased to offer this Spectacular high spec super bedsit to rent. The property consists of a HUGE room with a private fully fitted kitchen and a communal bathroom. The property also benefits from a patio area and air conditioning. Located in a highly sought after location in central Golders Green, approx. 10 min walk to the station. Available Now!
EPC RATING B

- Private Fully Fitted Kitchen
- High Standard Finish
- Includes all bills
- INTERNET INCLUDED
- AVAILABLE NOW
- Off Street Parking
- Patio Area
- Communal Bathroom
- Modern
- Close to station and shops



— Lower Ground Floor



GROSS INTERNAL AREA (GIA)
The footprint of the property.
34.8 Sqm / 374.7 Sqft



NET INTERNAL AREA (NIA)
Excludes walls and external features.
Includes washrooms, restricted head
34.1 Sqm / 367.3 Sqft



EXTERNAL STRUCTURAL FEATURES
Balconies, terraces, verandas etc.
0.0 Sqm / 0.0 Sqft



RESTRICTED HEAD HEIGHT
Limited use area under 1.5m
0.0 Sqm / 0.0 Sqft