



**MILES ESTATE AGENTS**

**57 Darby Way Bishops Lydeard  
Taunton TA4 3BD**





A lovely, spacious 2 double bedroom semi detached house overlooking the green and in fantastic corner plot gardens with well presented accommodation in ever popular Bishops Lydeard. Superb kitchen/dining room and useful study/boot room - early viewing highly recommended.







## Features:

- Entrance Hall
- Spacious Dual Aspect Lounge
- Superb Kitchen/Dining Room
- Study/Boot Room
- 2 Good Size Double Bedrooms
- Family Bathroom
- Generous Corner Plot Gardens
- Council Tax Band B





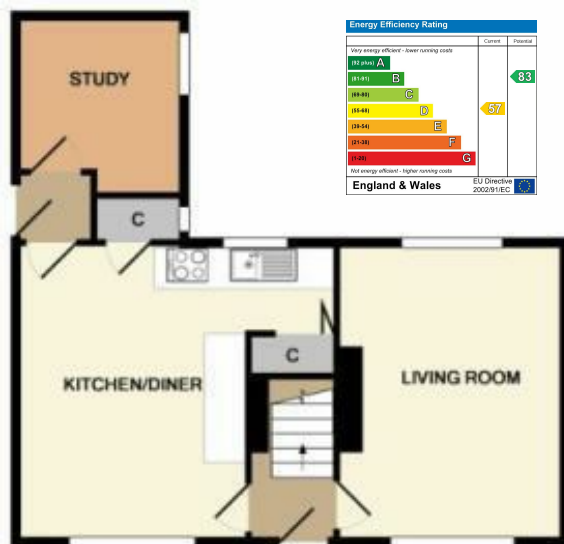

GROUND FLOOR



1ST FLOOR

Whilst every attempt has been made to ensure the accuracy of the floor plan contained here, measurements of doors, windows, rooms and any other items are approximate and no responsibility is taken for any error, omission, or mis-statement. This plan is for illustrative purposes only and should be used as such by any prospective purchaser. The services, systems and appliances shown have not been tested and no guarantee as to their operability or efficiency can be given.  
Made with Metropix 02017



Viewings strictly through the selling agents:

**Miles Estate Agents**

2 Piffin Lane, Bishops Lydeard, Taunton,  
Somerset, TA4 3AS

**Tel: 01823 470 500**

[lydeard@milesestateagents.co.uk](mailto:lydeard@milesestateagents.co.uk)

[www.milesestateagents.co.uk](http://www.milesestateagents.co.uk)

**rightmove** 

**Zoopla.co.uk**

**onTheMarket.com**

**MILES ESTATE AGENTS**

