



## Cavalier House | London | W5

£440,000

Positioned on the fourth floor in the iconic Cavalier House development in the heart of Ealing. A development that is very popular with buyers and corporate tenants given its central location in the heart of Ealing, parking designated for every flat, 24 hour security concierge and being set above the award winning Eden Fitness Gym and Spa.

- LARGE ONE BEDROOM
- FORTH FLOOR
- SECURED GATED PARKING
- GYM & LEISURE FACILITIES
- CONCIERGE

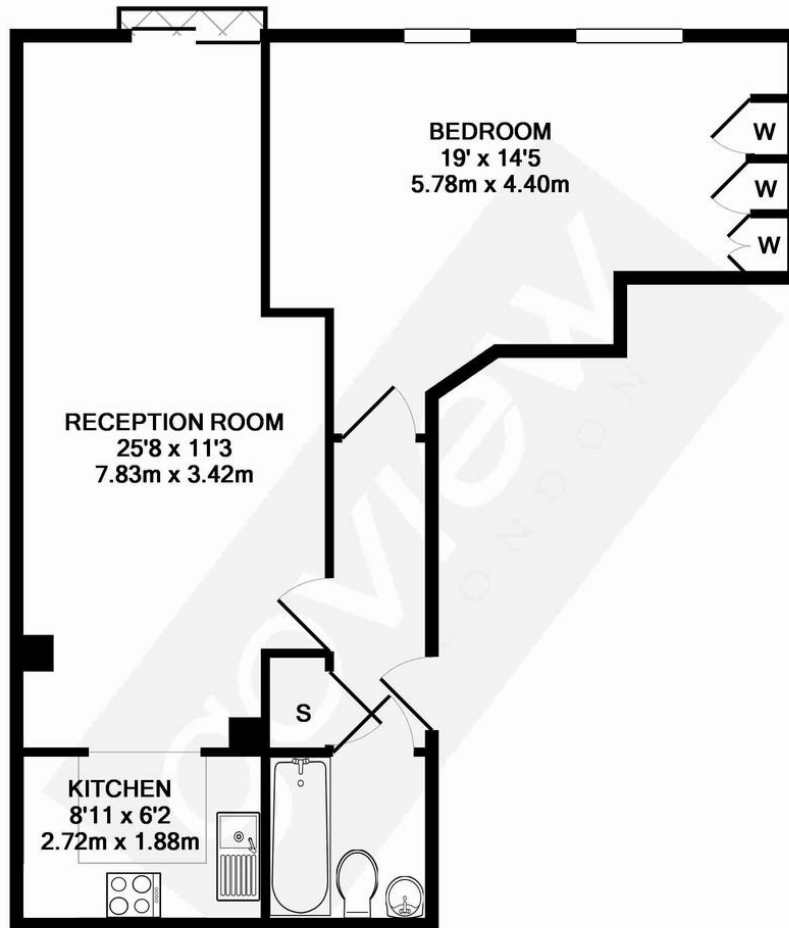

TOTAL APPROX. FLOOR AREA 627 SQ.FT. (58.2 SQ.M.)

Whilst every attempt has been made to ensure the accuracy of the floor plan contained here, measurements of doors, windows, rooms and any other items are approximate and no responsibility is taken for any error, omission, or mis-statement. This plan is for illustrative purposes only and should be used as such by any prospective purchaser. The services, systems and appliances shown have not been tested and no guarantee as to their operability or efficiency can be given  
Made with Metropix ©2016

## Contact Details

24 Station Parade  
Ealing  
London  
W5 3LD

[www.goviewlondon.co.uk](http://www.goviewlondon.co.uk)  
[sales@goviewlondon.co.uk](mailto:sales@goviewlondon.co.uk)  
020 8992 0333

Agents Note: Whilst every care has been taken to prepare these sales particulars, they are for guidance purposes only. All measurements are approximate are for general guidance purposes only and whilst every care has been taken to ensure their accuracy, they should not be relied upon and potential buyers are advised to recheck the measurements