

13 The Beeches Mews, West Didsbury, M20 2PF



JP&Brimelow
SALES

Price: £390,000

A light & bright, **THREE DOUBLE BEDROOMS**, modern, mid-townhouse within this highly popular development positioned off Barlow Moor Road known as The Beeches Mews in West Didsbury. Within a short stroll from both West Didsbury and Burton Road with its array of independent boutique shops, popular bars, restaurants and the Metrolink station in West Didsbury giving you direct access into the City centre/Manchester International Airport and Media City. The well-planned accommodation comprises; entrance hallway with stairs leading to all floors, a downstairs W.C., bedroom three and a fitted kitchen/dining room to the ground floor leading out into the rear enclosed decked rear garden. To the first floor there a landing leading to an L shaped lounge/family room. Whilst the second floor reveals two further double bedrooms and a four-piece family bathroom. The property benefits from gas fired central heating, double glazed throughout and a paved driveway providing off road parking to the front aspect. Early viewing is highly recommended due to the location.





EPC Chart

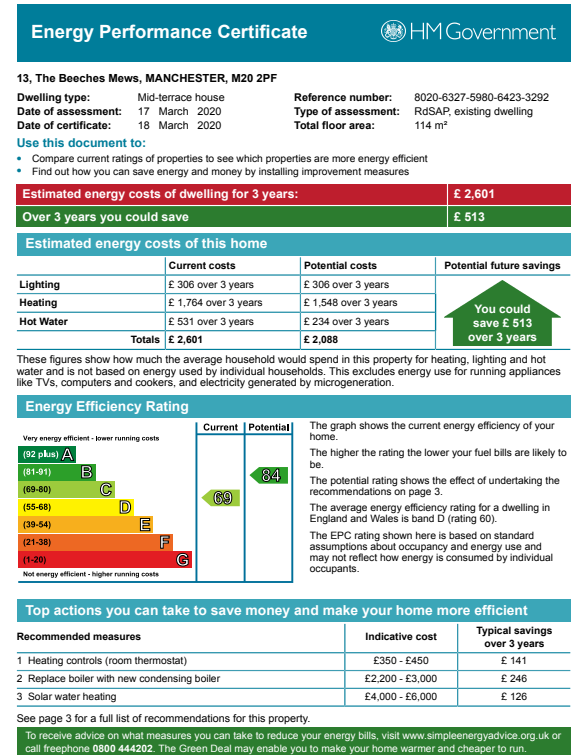

Leasehold - share of freehold Shared FREEHOLD through Beech Park Management. This is collective of Beeches Mews property owners. March 2020. Council Tax Band: D

Ground Floor

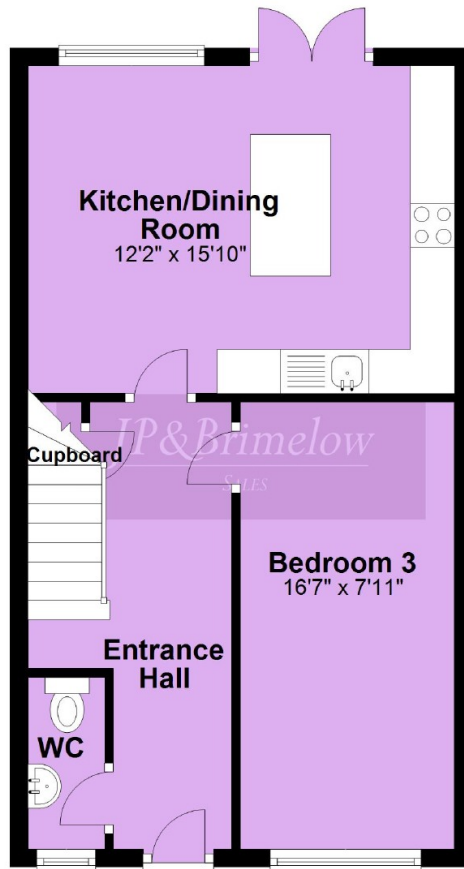

First Floor

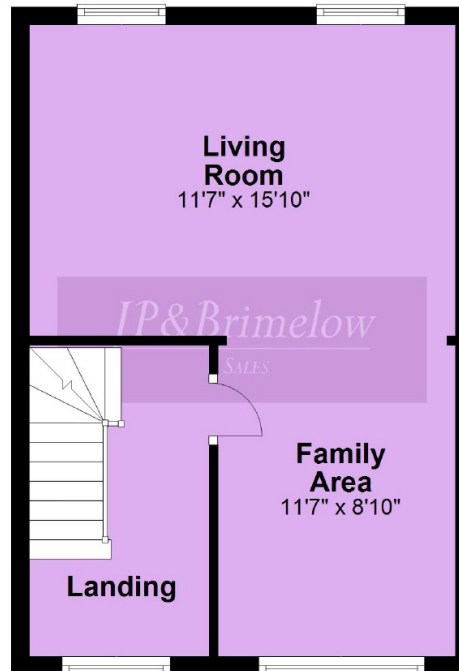

Second Floor

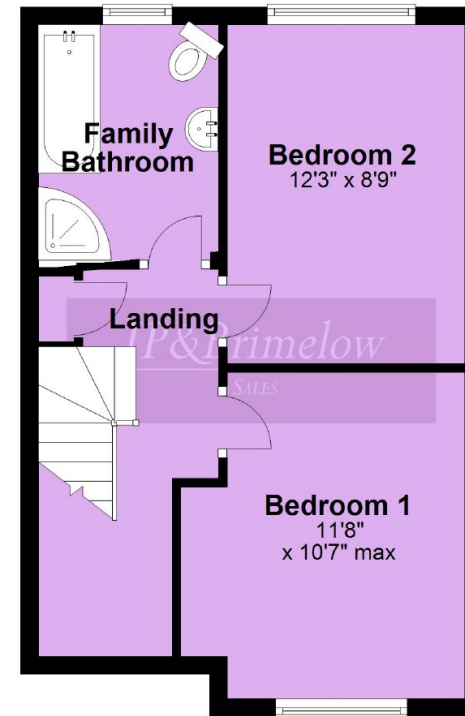

Chorlton & Didsbury Sales
430 Barlow Moor Road, Chorlton, Manchester, M21 8AD
Chorlton: 0161 882 2233 Didsbury: 0161 448 0622
E: chorlton@jpbrimelow.co.uk www.jpandbrimelow.co.uk



JP&Brimelow
SALES

NOTICE: JP & Brimelow Chorlton & Didsbury Ltd for themselves and for the vendors or lessors of this property whose agents they are give notice that:

- (i) the particulars are set out as a general outline only for the guidance of intending purchasers or lessees, and do not constitute, nor constitute part of, an offer or contract;
- (ii) all descriptions, dimensions, references to the condition and necessary permissions for use and occupation, and other details are given in good faith and are believed to be correct but any intending purchasers or tenants should not rely on them as statements or representations of fact but must satisfy themselves by inspection or otherwise as to the correctness of each of them;
- (iii) no person in the employment of JP & Brimelow Ltd has any authority to make or give any representation or warranty whatever in relation to this property.



Follow us on Twitter @jpandbrimelows