



- VIEWING IS HIGHLY RECOMMENDED
- DELIGHTFUL FAMILY HOME
- WELCOMING LOUNGE
- MODERN FITTED KITCHEN

71 Tavistock Road, Acocks Green, Birmingham, B27 7JE

Fantastic Traditional 3 DOUBLE BEDROOM semi-detached in VERY POPULAR LOCATION, having the benefit of DOUBLE GLAZING AND GAS FIRED CENTRAL HEATING, delightful Lounge and MODERN FITTED KITCHEN, replacement FIRST FLOOR BATHROOM, off street parking and LANDSCAPED REAR GARDEN. The property benefits from a COMBI BOILER with Nest system and a security system.



Property Description

DESCRIPTION

We strongly recommend internal viewing of this rare three double bedroom family home lying back behind its very own driveway. Offering swift access to both Solihull and Shirley as well as convenience for Birmingham City Central.

This is a real gem offering a great location and good sized accommodation to include Porch, Guest WC, Lounge, Kitchen/Dining Room, Modern Kitchen, Three double Bedrooms and a Family Bathroom. The property benefits from double glazing throughout and a recently fitted Combi boiler with Nest system and security cameras to both the front and rear.



OUTSIDE

The property has the benefit of driveway parking and landscaped rear garden.



GENERAL INFORMATION

Tenure: We are advised by the vendor that the property is Freehold with vacant possession upon completion. However, we would advise that you check this with your legal advisor before exchanging contracts.

Services: All mains services are connected to the property. However, it is advised that you confirm this at point of offer.

Local Authority: Birmingham City Borough Council.

OTHER SERVICES

DM & Co are pleased to offer the following services:-

Residential Lettings: If you are considering renting a property or letting your property, please contact the office on 0121 775 0101.

Mortgage Services: If you would like advice on the best mortgages available, please contact us on 0121 775 0101.

VIEWINGS

At short notice with DM & Co. Homes on 0121 775 0101 or by email sales@dmmandcohomes.co.uk.

WANT TO SELL YOUR PROPERTY

Call DM & Co. Homes on 0121 775 0101 to arrange your FREE no obligation market appraisal and find out why we are Solihull's fastest growing Estate Agency.

Agents Note: Whilst every care has been taken to prepare these sales particulars, they are for guidance purposes only. All measurements are approximate are for general guidance purposes only and whilst every care has been taken to ensure their accuracy, they should not be relied upon and potential buyers are advised to recheck the measurements.

Ground Floor

Approx. 39.6 sq. metres (425.9 sq. feet)

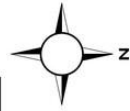
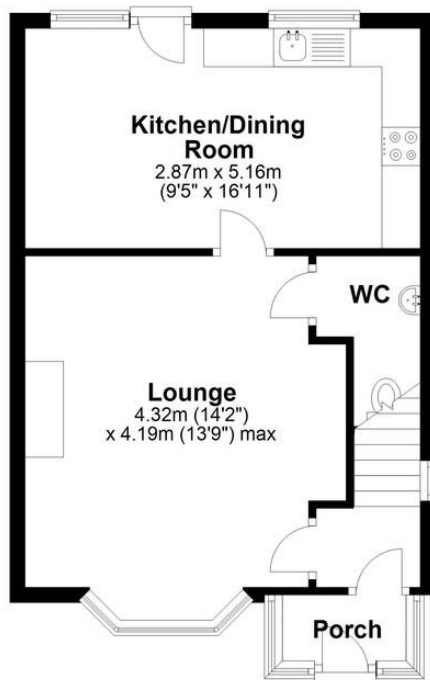

First Floor

Approx. 37.7 sq. metres (405.5 sq. feet)

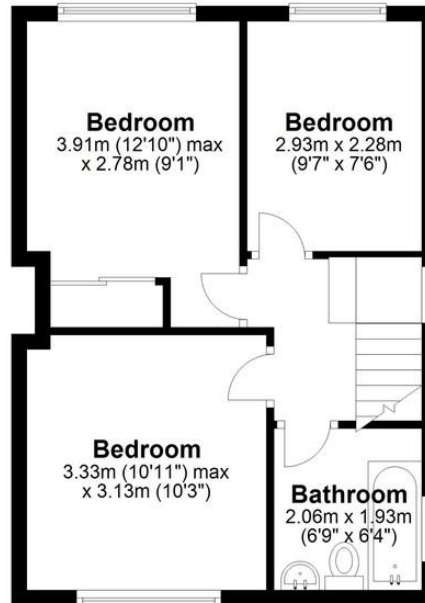

Total area: approx. 77.2 sq. metres (831.4 sq. feet)

Please note this plan is for illustration purposes only, this is not intended to be a measured survey or comply with RICS guidelines. All measurements are approximate and should be checked by prospective buyers/tenants. No responsibility is taken for any error, omission, or mis-statement.
Plan produced using PlanUp.

