



Room 3, Flat 2 48 Reginald Street, Luton, Bedfordshire, LU2 7QZ
£500



- Large Double Room In House Share
- Close to Town Center

- Fully Furnished
- Walking Distance To Station

- All Bills Included
- Luxury Accommodation

*** EXCLUSIVE TO P&R PROPERTY LETTINGS *** LUXURY ROOM ** FULLY FURNISHED TO A HIGH STANDARD ** PROFESSIONAL ONLY HOUSE SHARE
 ** SHARED BATHROOM ** CLOSE TO TOWN CENTRE ** ALL BILLS INCLUDED ** WI-FI ** AVAILABLE OCTOBER 2020 **

FIRST FLOOR

ENTRANCE HALL

LOUNGE 11'11" X 8'9" (3.62M X 2.67M)

KITCHEN/BREAKFAST ROOM 12'5" X 7'9" (3.79M X 2.36M)

ROOM 1 8'2" X 13'2" (2.50M X 4.02M)

EN-SUITE

ROOM 2 8'1" X 11'2" (2.47M X 3.40M)

EN-SUITE

SECOND FLOOR

LANDING / STORAGE AREA

ROOM 3 11,5 * 10,5 (3.35M,1.52M * 3.05M,1.52M)

ROOM 4 10.8 * 9,9 (3.05M.2.44M * 2.74M,2.74M)

SHOWER ROOM

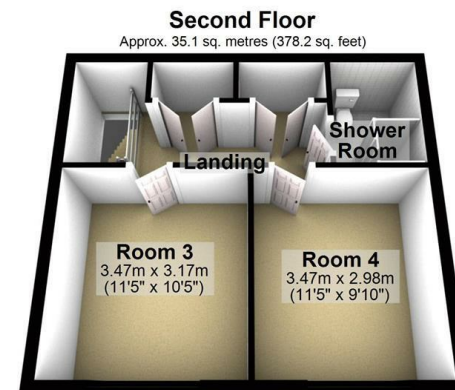
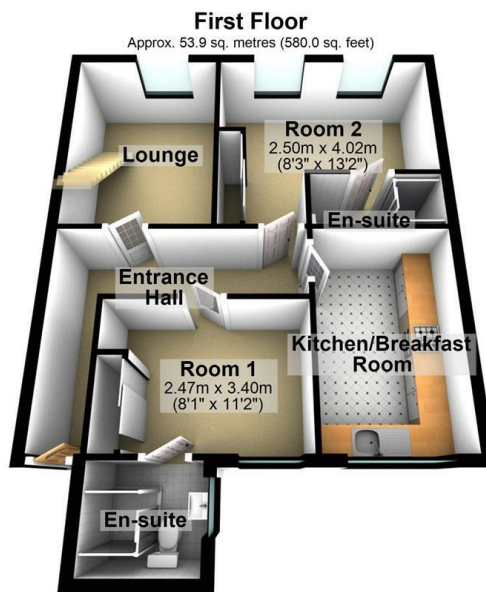

Total area: approx. 89.0 sq. metres (958.2 sq. feet)

Energy Efficiency Rating		Current	Potential
Very energy efficient - lower running costs			
(92 plus)	A		
(81-91)	B		
(69-80)	C		
(55-68)	D		
(39-54)	E		
(21-38)	F		
(1-20)	G		
Not energy efficient - higher running costs			
England & Wales		EU Directive 2002/91/EC	