



## Northgate

Darlington DL1 1TL

£90,000





This footer paragraph is an example only and should not be relied upon as complying with current legislation. These particulars, whilst believed to be accurate are set out as a general outline only for guidance and do not constitute any part of an offer or contract. Intending purchasers should not rely on them as statements of representation of fact, but must satisfy themselves by inspection or otherwise as to their accuracy. No person in this firm's employment has the authority to make or give any representation or warranty in respect of the property.



[www.venturepropertiesuk.com](http://www.venturepropertiesuk.com)

# Northgate

Darlington DL1 1TL



- Completely refurbished
- Town centre living
- Modern throughout

- Quality fixtures and fittings
- One bedroom
- Council Tax Band TBC

- Perfect for professionals
- Open plan living
- EPC Rating TBC

A completely refurbished development of six individual stylish one bed apartments located in a prime location in Darlington town centre.

Apartment six is situated on the top floor of the development and would ideally suit the needs of a professionals looking for low maintenance, modern open plan town centre living in the heart of Darlington town centre.

In brief the apartment comprises : entrance hallway, open plan kitchen and living area, double bedroom and good size bathroom.

The apartment offers brand new high quality fixtures and fittings including washer, fridge/freezer, ceramic hob, oven and extractor, kitchen island and 2 bar stools and all blinds and shutters.

An early viewing is highly recommend.

## Hall

with audio intercom entry system, laminate flooring with access to all rooms

## Lounge/Kitchen

21'1" x 10'1" (6.444 x 3.078)

A light and bright open plan room with 3 x double

glazed windows all to the front elevation and gas central heating radiator. The modern kitchen comprises: wall drawer and floor units with contrasting work surfaces, stainless steel sink and mixer tap, integrated electric hob and oven with overhead stainless steel and glass extractor chimney, integrated fridge and freezer, washing machine, ceiling spotlights and laminate flooring.

## Bedroom

13'1" x 11'1" (3.994 x 3.399)

A good size double bedroom with double glazed window to the rear, laminate floor and gas central heating radiator.

## Bathroom

7'7" x 6'7" (2.320 x 2.017)

A larger than average bathroom with walk in rain shower in a glass cubicle, wash handbasin with under storage, WC, part tiled walls, wall mounted chrome towel dryer and laminate flooring.

## Communal

The apartment shares a communal area where bins and bicycles can be stored.

## Note

There is a new central heating boiler.

## GROUND FLOOR

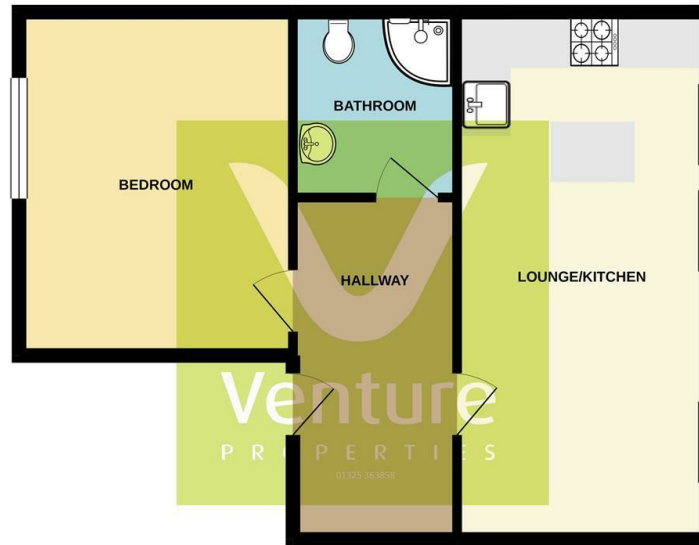

Whilst every attempt has been made to ensure the accuracy of the floorplan contained here, measurements of doors, windows, rooms and any other items are approximate and no responsibility is taken for any omission or mis-statement. This plan is for illustrative purposes only and should be used as such by any prospective purchaser. The services, systems and appliances shown have not been tested and no guarantee as to their operability or efficiency can be given.  
Made with Mapogen ©2020

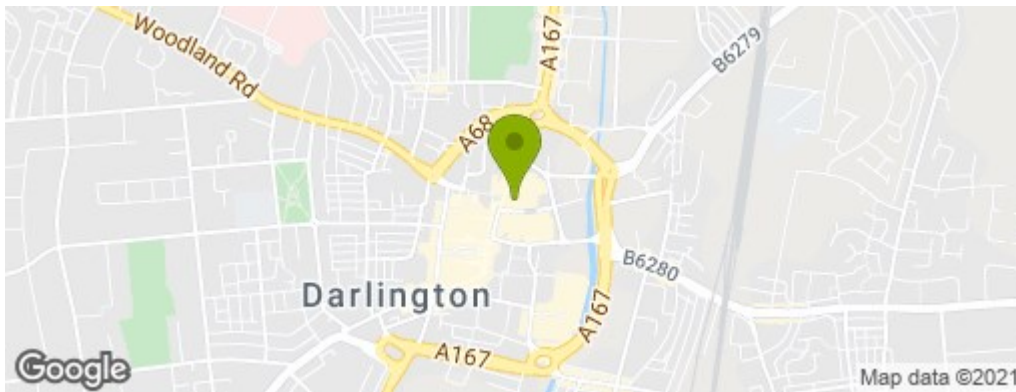

## Property Information

**01325 363858**

45 Duke Street, Darlington, County Durham, DL3 7SD  
sales@venturepropertiesuk.com