



****AVAILABLE IMMEDIATELY****
****FURNISHED**** ****TOP FLOOR**
APARTMENT WITH BALCONY**
****STUNNING CITY VIEWS**** ****OFF**
STREET PARKING** With superb views,
 this is a great two-bedroom apartment at the
 popular development of Curzon Place,
 Gateshead. Just opposite the Hilton Hotel,
 Curzon Place, is just a short walk from
 Newcastle's Quayside, Newcastle City
 Centre and all the conveniences that
 Gateshead has to offer, perfect for anyone
 working in the city.

With lift access, the accommodation briefly
 comprises; L-shaped entrance hall with
 separate store cupboard; two bedrooms, both
 comfortable doubles and with great views,
 the master also with en-suite shower room,
 wall mounted TV and a private balcony;
 family bathroom WC; impressive open plan
 kitchen and lounge/diner, with feature
 curved picture windows looking out over
 Newcastle City Centre including the Tyne
 Bridge and Gateshead's Sage Music Venue.

Well presented throughout, fully furnished
 and with secure underground parking, this
 wonderful property is not to be missed!

Available Immediately | £795pcm | Top
 Floor Apartment | 611 sq ft (56.8m²) | Two
 Double Bedrooms | Superb Views | Private
 Balcony | Open Plan Kitchen &
 Lounge/Diner | Bathroom & En-Suite |
 Secure Underground Parking | Lift Access |



Great Location | Furnished | Elec Heating
 & DG | EPC Rating: B

GROUND FLOOR
 611 sq.ft. (56.8 sq.m.) approx.

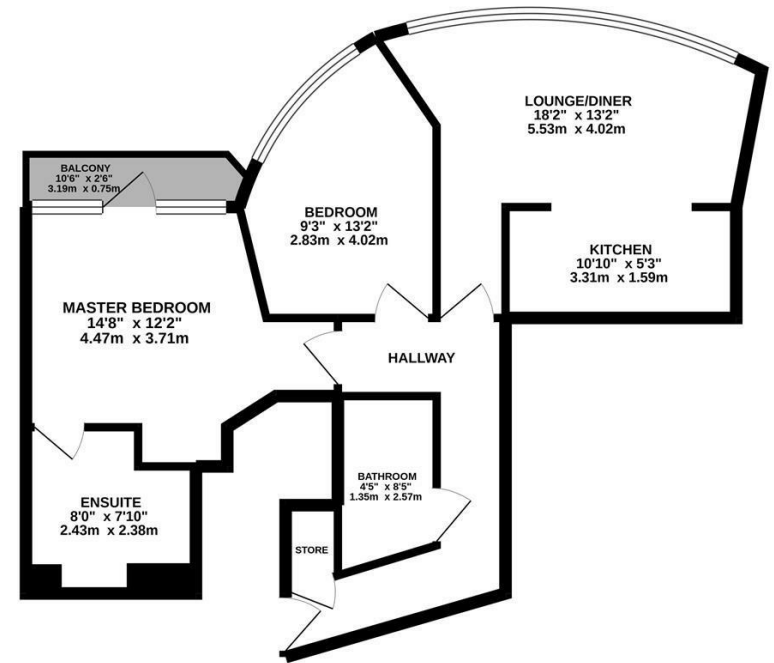

TOTAL FLOOR AREA: 611 sq.ft. (56.8 sq.m.) approx.
 Whilst every attempt has been made to ensure the accuracy of the floorplan contained herein, measurements
 of doors, windows, rooms and any other items are approximate and no responsibility is taken for any error,
 omission or mis-statement. This plan is for illustrative purposes only and should be used in conjunction with any
 prospective purchaser. The services, systems and appliances shown have not been tested and no guarantee
 as to their operability or efficiency can be given.
 Made with Metropix ©2020



£795 PCM

Misrepresentation Act 1967. These particulars and the descriptions and measurements herein do not constitute representation and whilst every effort has been made to ensure accuracy, this cannot be guaranteed.

