



SALES

LETTINGS

MANAGEMENT

chiswick@tatepartnership.co.uk

020 8996 0000

TATEPARTNERSHIP.CO.UK



Chiswick Lane, Chiswick

£385,000

A delightful first floor one bedroom conversion flat, newly Decorated, new fitted Carpets, new Blinds and all new fitted Radiators. Located just a few minutes walk from Chiswick High Road. The accommodation; entrance hall, bright open plan living/dining/kitchen, good double bedroom with wall to wall wardrobes and an en-suite bathroom. The outlook to the front is over the park. Chiswick Lane runs directly off Chiswick High Road, so all central transport/shopping/dining facilities are within easy walking distance and a few minutes in the other direction are stunning walks along the River Thames. Being Sold with Full Vacant Possession and favoured Share of Freehold.

Chiswick Lane, Chiswick

Floor Plan

Approximate gross internal area
41 sq m / 437 sq ft

Chiswick Lane, London, W4

Approximate Gross Internal Area = 40.6 sq m / 437 sq ft

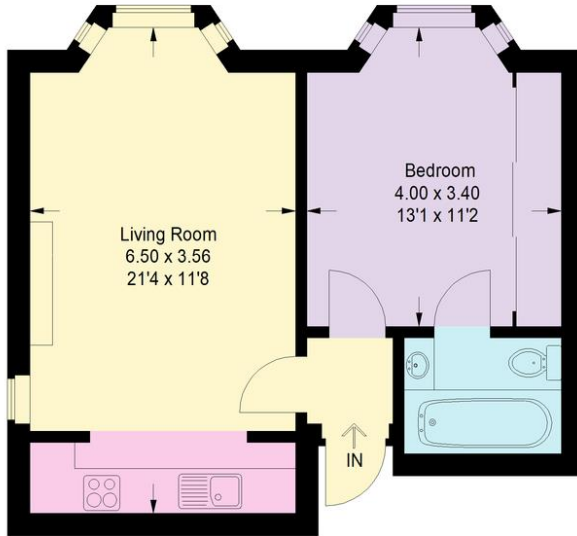

Illustration for identification purposes only, measurements are approximate, not to scale.
FloorplansUsketch.com © 2020 (ID691516)

EPC

