



*Jordan Fishwick*

GREEN QUARTER  
Cypress Place



## Cypress Place, Green Quarter M4 4EH Price £175,000



### The Property

Online Video Tour.....<https://www.youtube.com/watch?v=sZI6csNAftc>

#### Cash Buyers Only!

This spacious 14th floor two bedroom apartment is set in Cypress Place which is located within the Green Quarter development, only a short walk from Market Street, Arndale Centre and Victoria Train and Metrolink Stations. The property has an open plan kitchen/living area with the kitchen is of a high quality and has a fully integrated fridge freezer, dishwasher, microwave and oven. Both bedrooms are generous size doubles with the master bedroom boasting an en-suite shower room. There is also a contemporary three-

piece family bathroom off the hallway. The apartment also benefits from having no ongoing chain.

### Directions

Cypress Place is located in the Green Quarter which is a short stroll from Victoria Train Station, The Printworks and MEN Arena.



- CASH BUYERS ONLY
- Two Bedroom Apartment
- Two Bathrooms
- 14th Floor
- Balcony
- Well Kept Communal Gardens
- No Parking

**Postcode** - M4 4EH

**EPC Rating** - C

**Floor Area** - sq ft

**Local Authority** - Manchester Council

**Council Tax** - Band D



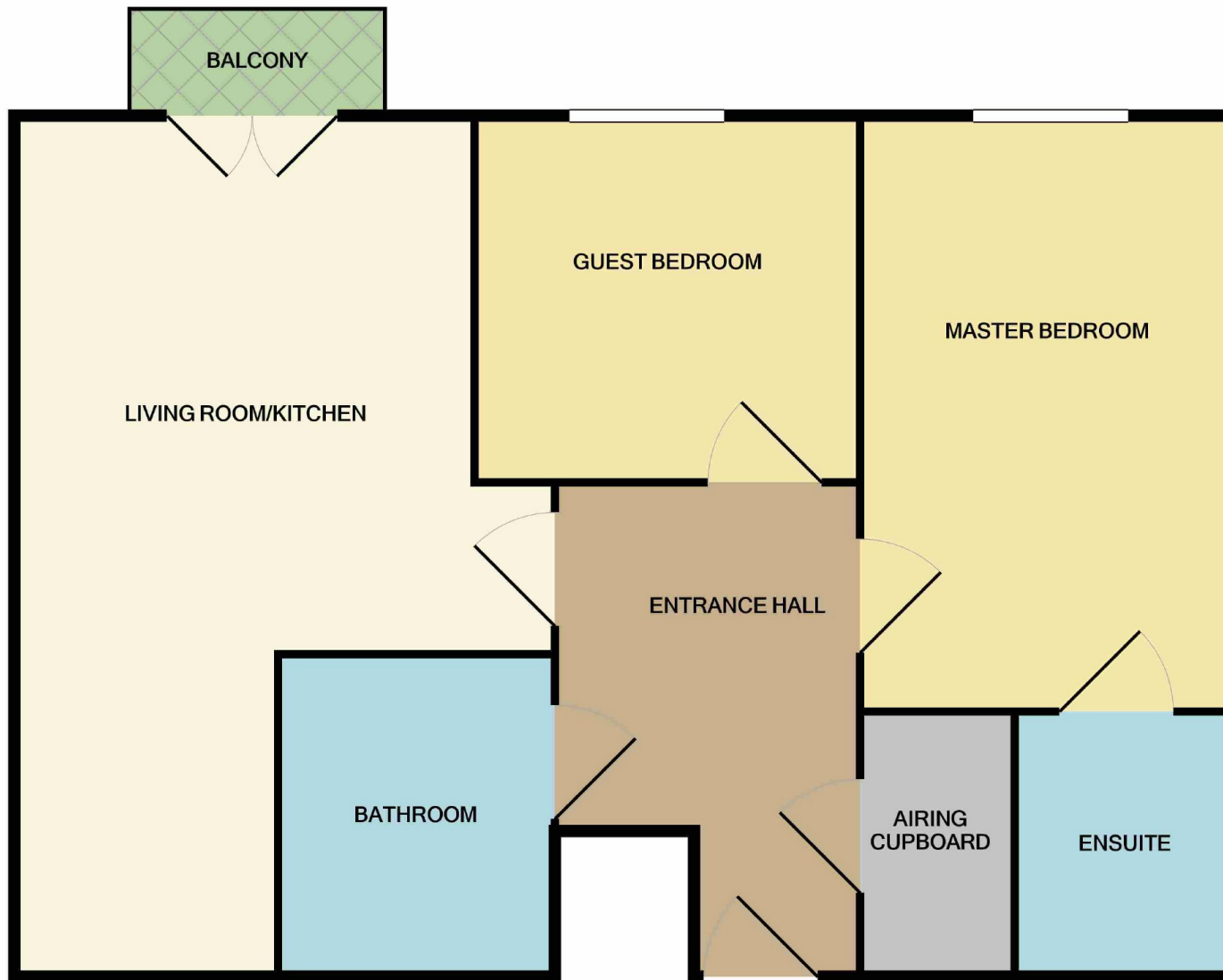

Measurements are approximate. Not to scale. Illustrative purposes only  
 Made with Metropix ©2020



These particulars are believed to be accurate but they are not guaranteed and do not form a contract. Neither Jordan Fishwick nor the vendor or lessor accept any responsibility in respect of these particulars, which are not intended to be statements or representations of fact and any intending purchaser or lessee must satisfy himself by inspection or otherwise as to the correctness of each of the statements contained in these particulars. Any floorplans on this brochure are for illustrative purposes only and are not necessarily to scale.

Offices also at:  
 Chorlton | Didsbury | Disley | Glossop | Hale | Macclesfield | Manchester | Sale | Wilmslow | Withington

68 The Arches, Whitworth Street West, Manchester, M1

**0161 833 9499**

manchester@jordanfishwick.co.uk  
 www.jordanfishwick.co.uk