



## 30 Dunelm Grove

, SE27 9JZ

**£1,800 PCM**

A three double bedroom terraced house offered to the market in immaculate condition. The property has a contemporary fitted kitchen/diner and bathroom, attached garage, and rear garden.

- A THREE DOUBLE BEDROOM TERRACED HOUSE
- CONTEMPORARY FITTED KITCHEN/DINER
- CENTRAL HEATING
- CLOAKROOM
- DOUBLE GLAZED WINDOWS
- ATTACHED GARAGE
- MODERN WHITE FITTED BATHROOM SUITE

### Viewing

Please contact our West Norwood Office on if you wish to arrange a viewing appointment for this property or require further information.



3



1



1

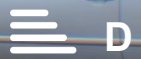

D

## Floor Plan

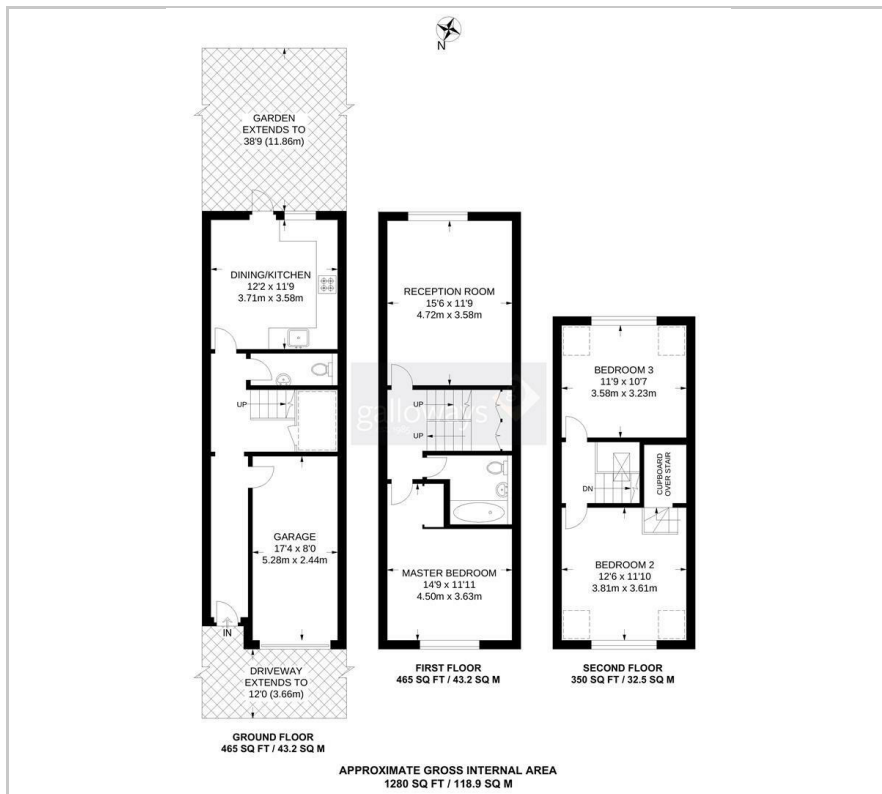

## Area Map



## Energy Efficiency Graph

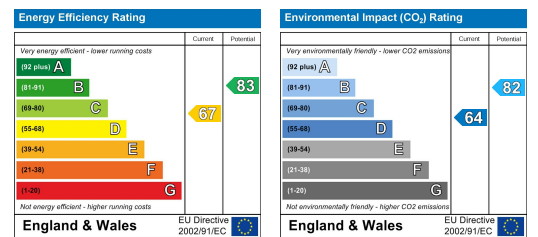

These particulars, whilst believed to be accurate are set out as a general outline only for guidance and do not constitute any part of an offer or contract. Intending purchasers should not rely on them as statements of representation of fact, but must satisfy themselves by inspection or otherwise as to their accuracy. No person in this firm's employment has the authority to make or give any representation or warranty in respect of the property.