



Flat 2, 140 Knights Hill

West Norwood, SE27 0SR

Asking Price £315,000

A beautiful Victorian conversion offered to the market in excellent condition. The property benefits from an en-suite bathroom off the Master bedroom, a contemporary open plan kitchen/living area and is situated just a short walk from West Norwood train station, making it an ideal location for a commute into central London.

- A FIRST FLOOR TWO BEDROOM APARTMENT
- CONTEMPORARY OPEN PLAN KITCHEN/RECEPTION
- HIGH SPEC FITTED SHOWER ROOM
- MASTER BEDROOM WITH EN-SUITE BATHROOM
- WOOD FLOORING
- 6 MINUTE WALK TO WEST NORWOOD STATION
- 17 MINUTE WALK TO TULSE HILL STATION
- (WALKING TIMES ESTIMATED BY GOOGLE MAPS)

Viewing

Please contact our West Norwood Office on if you wish to arrange a viewing appointment for this property or require further information.



2



2



1



Floor Plan

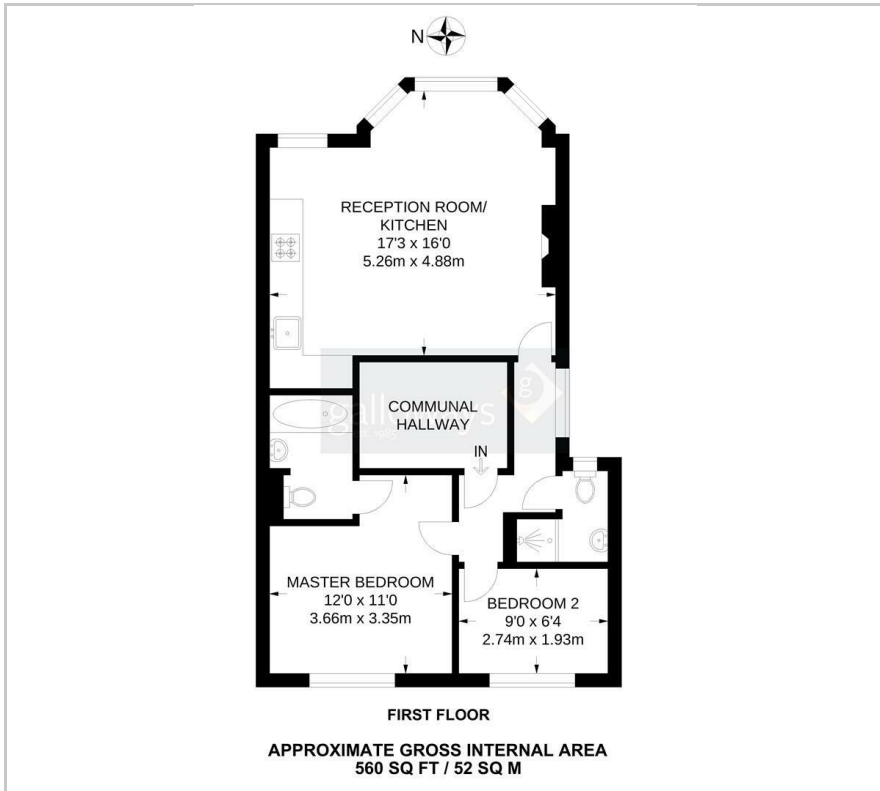

Area Map



Energy Efficiency Graph

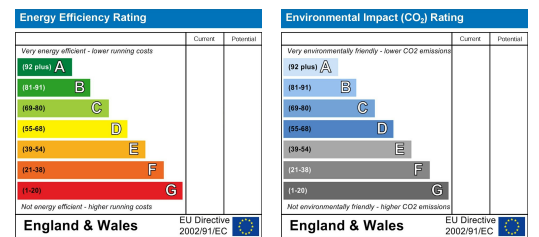

These particulars, whilst believed to be accurate are set out as a general outline only for guidance and do not constitute any part of an offer or contract. Intending purchasers should not rely on them as statements of representation of fact, but must satisfy themselves by inspection or otherwise as to their accuracy. No person in this firm's employment has the authority to make or give any representation or warranty in respect of the property.