



Jordan fishwick

SALFORD
The Mill



The Mill, Salford M5 4JH

Asking price £170,000



The Property

Online Video tour....<https://youtu.be/ewNvvHNmXJs>

An exceptional third floor apartment in this popular and established development a short distance from the vibrant city centre. This fabulous city pad features an entrance hallway, open plan living/kitchen area with floor to ceiling windows with unobstructed water views, spacious master bedroom and a well-proportioned second double bedroom and. Upgraded Stylish and contemporary bathroom. Allocated Parking Space Included.

Directions

- Third Floor
- Two Double Bedrooms
- Water Views
- Parking Space
- Excellent Road Links
- Lovely Aspect
- Updated Bathroom Suite
- Tenanted Until July 2016

Postcode - M5 4JH

EPC Rating - B

Floor Area - sq ft

Local Authority - Salford Council

Council Tax - Band B



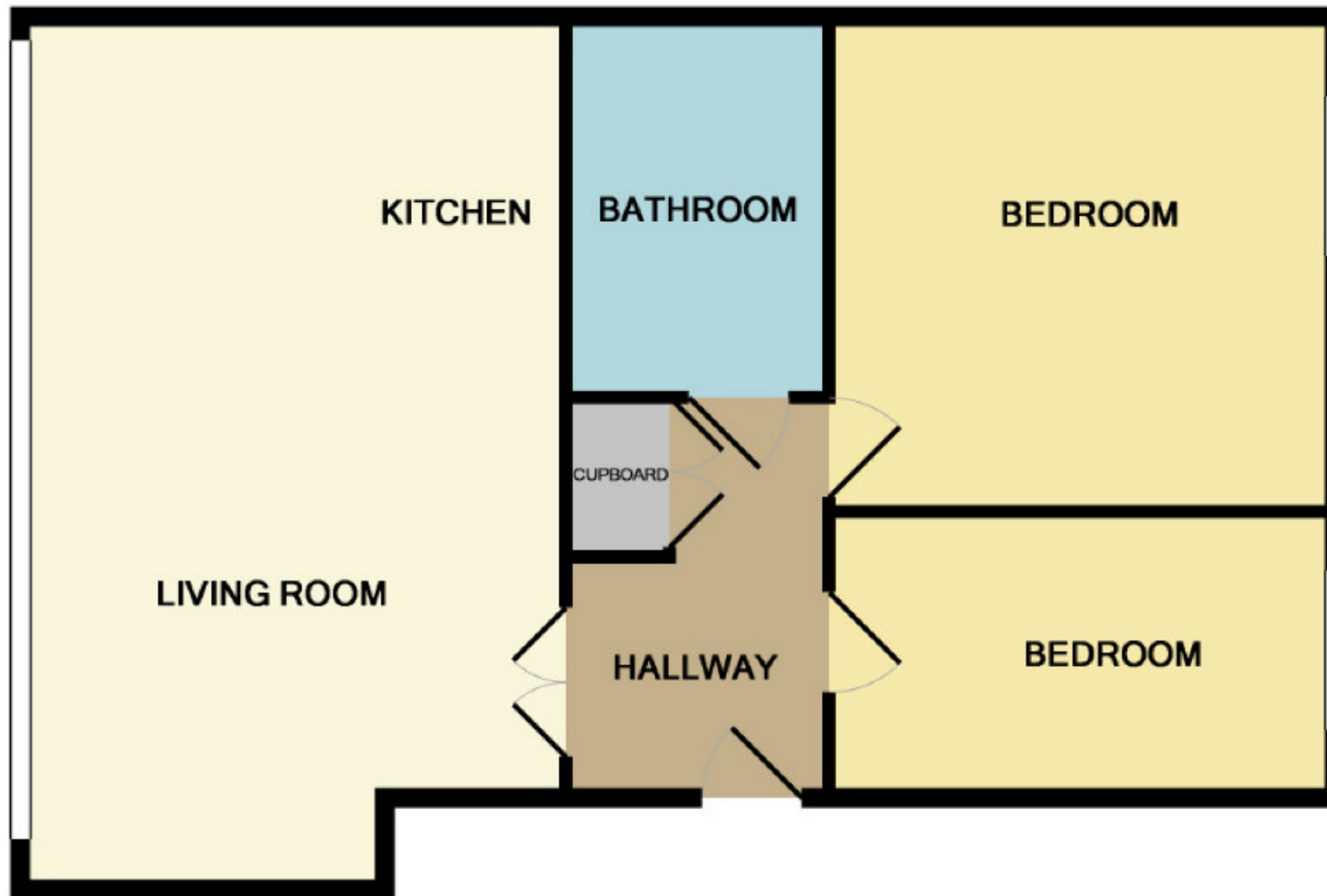

Measurements are approximate. Not to scale. Illustrative purposes only
Made with Metropix ©2015



These particulars are believed to be accurate but they are not guaranteed and do not form a contract. Neither Jordan Fishwick nor the vendor or lessor accept any responsibility in respect of these particulars, which are not intended to be statements or representations of fact and any intending purchaser or lessee must satisfy himself by inspection or otherwise as to the correctness of each of the statements contained in these particulars. Any floorplans on this brochure are for illustrative purposes only and are not necessarily to scale.

Offices also at:
Chorlton | Didsbury | Disley | Glossop | Hale | Macclesfield | Manchester | Sale | Wilmslow | Withington

68 The Arches, Whitworth Street West, Manchester, M1

0161 833 9499

manchester@jordanfishwick.co.uk
www.jordanfishwick.co.uk