



The Arbour 34 Widney Road

Knowle, Solihull, B93 9DY

£950



Senate Property Services are pleased to offer this furnished two double bedroom ground floor apartment with allocated and visitors parking. Located close to local amenities and with M42 Motorway close by. Benefiting from double glazing, gas central heating and comprising of secure communal entrance with intercom system, entrance hallway, lounge/diner/kitchen with double opening doors, kitchen with integrated dishwasher, fridge/freezer and washing machine, utility/laundry room, master bedroom with fitted wardrobes and en-suite shower room, second double bedroom and principle bathroom with shower over bath.



Area Map



Floor Plan

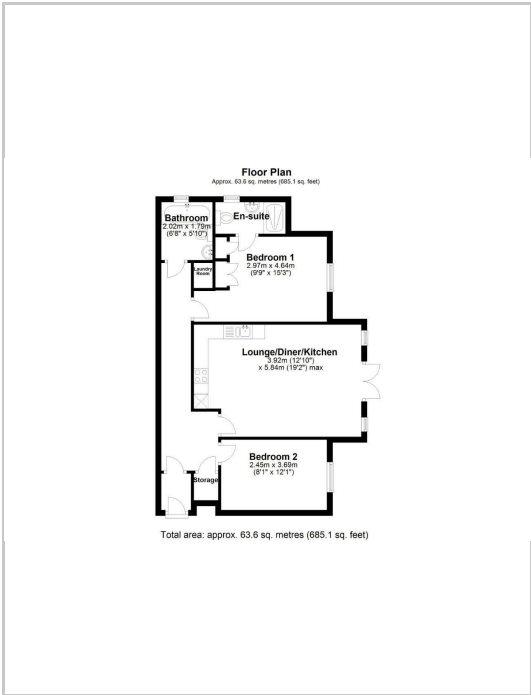

Energy Efficiency Graph

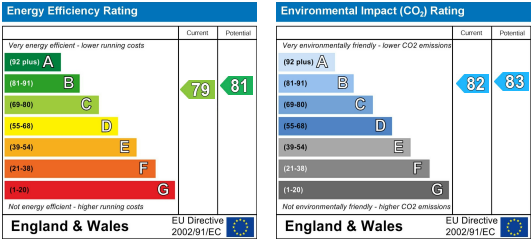

These particulars, whilst believed to be accurate are set out as a general outline only for guidance and do not constitute any part of an offer or contract. Intending purchasers should not rely on them as statements of representation of fact, but must satisfy themselves by inspection or otherwise as to their accuracy. No person in this firms employment has the authority to make or give any representation or warranty in respect of the property.