



Grosvenor Road, London, W4 4EQ

Guide Price £3,000,000

WHITMAN & CO.

SALES · LETTINGS · COMMERCIAL

- Unique detached double fronted family home
- Substantial plot with off street parking and garage
- Quiet residential street
- 3800 sqft of accomodation with further potential
- Separate 2-bed annexe
- Seven bedrooms in total

Tenure - Freehold
Local Authority - Hounslow
Council Tax - Band G

THE PROPERTY

A unique detached double fronted family home set on a generous plot with flexible accommodation and a huge amount of character. The house has an interesting history being the former home of Midge Ure, whose studio (now 2-bed annexe) in the back garden played host to the recording of the Band Aid song 'Do they know it's Christmas'. Set back from the street the main house comprises a generous front garden with off-street parking, entrance hall, stunning panelled triple aspect reception room, dining room, kitchen/breakfast room, garden room, master bedroom with ensuite, four further bedrooms, two further bathrooms, cellar/utility room, sauna with shower, lovely 64'x54'10 private garden and garage. Further accommodation includes a self-contained annexe comprising open plan kitchen/sitting room, double bedroom, a single bedroom and shower room. Totalling circa 3800 sqft the house, despite being in good condition, offers the ingoing purchase the opportunity to remodel and extend subject to the necessary consents. Grosvenor Road is a quiet tree-lined residential street within a short walk of Chiswick High Road's extensive facilities, the river and local parks including Kew Gardens. Transport links include Gunnersbury Station, local bus routes and the A4/M4 for routes in and out of London.

SITUATION

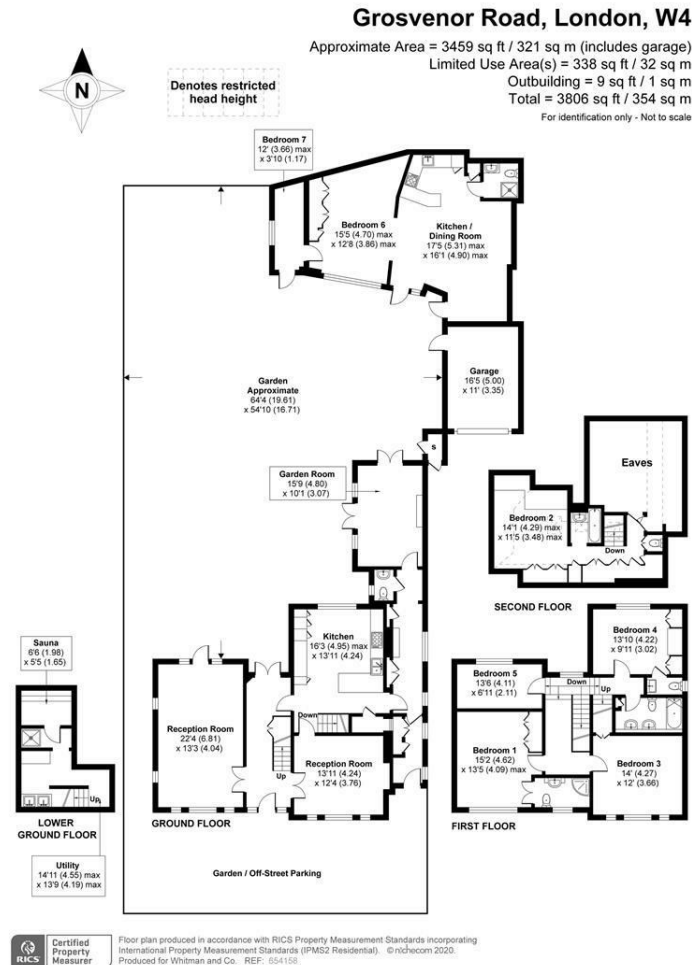

5-7 Turnham Green Terrace, Chiswick, London, W4 1RG

Tel 020 8747 8300

E-mail sales@whitmanandco.com

Website www.whitmanandco.com